

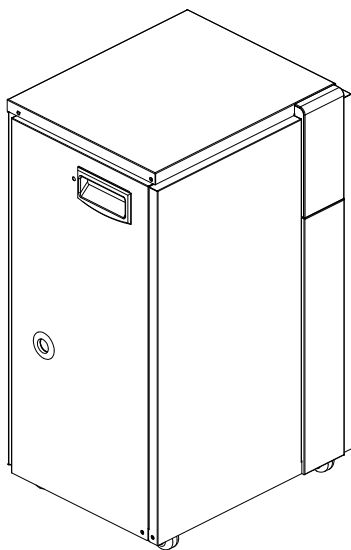

Commercial Dehumidifier User Manual



Please read this user manual before operating and save for future reference.

Model: DE190L

BEFORE FIRST USE:

Please leave the dehumidifier sitting outside the box for **24 HOURS** before plugging it in.

The dehumidifiers may have been tilted or placed upside down during shipping. Leave The dehumidifier sits for 24 hours so the oil in the compressor can settle from the move, Not doing so can affect the performance or lifespan of the dehumidifier.

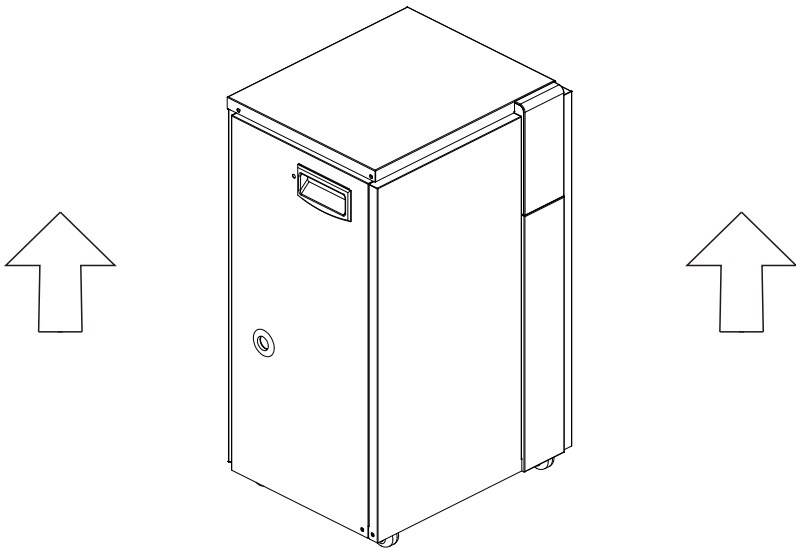

NOTE:

To continuously improve its products, LUBAIR reserves the right to modify this information without prior notification. For any questions during assembly, please check the instructions on the product page for reference. Or contact our customer service with any questions, comments, or concerns , We are online 24H for you. Thank you for using LUBAIR products in your home!

Welcome

Thanks for choosing LUBAIR dehumidifier!

LUBAIR is dedicated to keeping people healthy, comfortable and more enjoyable by offering quality appliances ranging from dehumidifiers to ice makers, and more. From breathing easier in your office to upgrading your kitchen appliances, we hope LUBAIR could help you every step of the way.

**READ THIS MANUAL INSTRUCTION CAREFULLY BEFORE USING THE UNIT.
PLEASE KEEP THIS FOR FUTURE REFERENCE.**

LUBAIR DE190L commercial dehumidifier can remove 190 PPD at saturation (95°F, 90% RH) and 90 PPD at AHAM (80°F, 60% RH) , reducing humidity to comfortable levels in a short period of time. This dehumidifier has a metal housing to withstand harsh environments, is safe and easy to use, guarantees long-term use and easy maintenance, plus we use a copper tube condenser and high quality and accurate sensors, it will be more effective and last longer.

Before plugging in your new dehumidifier, we suggest that you read this user manual as it contains important safety information, operation instructions, troubleshooting, maintenance tips, and warranty information to ensure the reliability and longevity of your dehumidifier.

We're always just an email away

To access customer support, please email to LubairServices@outlook.com with your purchase order.

Thank you again!

Table of Contents

Introduction.....	1
Safety Awareness.....	2
Instructions For Repairing Appliances Containing.....	5
Machine Structure Diagram.....	7
Operation Instruction.....	8
Drainage Mode.....	11
Repair and Maintenance.....	13
Troubleshooting.....	14
Safety Precautions.....	15
Service.....	16

Introduction

Thank you for choosing the dehumidifier by LUBAIR!

We hope it will bring great convenience to your work and life.

We recommend that you save the user manual properly for future reference.

Before using this product, please read the user manual carefully to ensure that this product functions at its best.

The LUBAIR's dehumidifier adopt an upgraded design, compact structure, easy to operate, and other characteristics, widely used in scientific research, basement, crawl space, greenery, laboratory, gymnasium, sanitation, commodity storage, underground engineering, and dehumidification in high humidity places such as kitchens, bathrooms, archives, warehouses, etc. Can be effectively avoided telecommunications equipment, materials, etc, are damaged due to dampness or rust.

Transportation and Custody

During transportation, this product should be handled preciously to prevent violent vibration. Generally, the packaged product should not be stored in the open air for a long time. It should be placed in a well-ventilated, non-corrosive gas warehouse. It should not be placed upside down. Rainproof measures should be adopted when stored temporarily.

Safety Awareness

VERY IMPORTANT!

Please do not install or use your dehumidifier before you have carefully read this manual. Please keep this instruction manual for an eventual product warranty and for future reference.

Warning

Do not use means to accelerate the defrosting process or to clean, other than those recommended by the manufacturer.

The appliance shall be stored in a room without continuously operating ignition sources (for example: open flames, an operating gas appliance or an operating electric heater.)

Do not pierce or burn.

Be aware the refrigerants may not contain an odour.



A2L

Warning(for R32)

Specific information regarding appliances with R32 refrigerant gas.

- Thoroughly read all of the warnings.
- When defrosting and cleaning the appliance, do not use any tools other than those recommended by the manufacturing company.
- The appliance must be placed in an area without any continuously sources of ignition(for example: open flames, gas or electrical appliances in operation).
- Do not puncture and do not burn.
- R32 is a refrigerant gas that complies with the United States directives on the environment.Do not, puncture any part of the refrigerant circuit.
- If the appliance is installed, operated or stored in an unventilated area, the room must be designed to prevent to the accumulation of refrigerant leaks resulting in a risk of fire or explosion due to ignition of the refrigerant caused by electric heaters, stoves, or other sources of ignition.
- The appliance must be stored in such a way as to prevent mechanical failure.
- Individuals who operate or work on the refrigerant circuit must have the appropriate certification issued by an accredited organization that ensures competence in handling refrigerants according to a specific evaluation recognized by associations in the industry.

-
- Repairs must be performed based on the recommendation from the manufacturing company. Maintenance and repairs that require the assistance of other qualified personnel must be performed under the supervision of an individual specified in the use of flammable refrigerants.
 - Ducts connected to an appliance shall not contain a potential ignition source.
 - WARNING-Risk Of Fire. Flammable Refrigerant Used. To Be Repaired Only By Trained Service Personnel. Do Not Puncture Refrigerant Tubing.
 - WARNING-Risk Of Fire. Dispose Of Properly In Accordance With Federal Or Local Regulations. Flammable Refrigerant Used.
 - WARNING-Risk Of Fire. Flammable Refrigerant Used. Consult Repair Manual/Owner's Guide Before Attempting To Service This Product. All Safety Precautions Must Be Followed.
 - WARNING-Risk of Fire due to Flammable Refrigerant Used. Follow Handling Instructions Carefully in Compliance with National Regulations.

General Safety Instruction

1. The appliance is for indoor use only.
2. Do not use the unit on a socket under repairs or not installed properly
3. Do not use the unit, follow these precautions:
 - A: Near to source of fire.
 - B: An area where oil is likely to splash.
 - C: An area exposed to direct sunlight.
 - D: An area where water is likely to splash.
4. All the air-conditioner sockets must comply with the local electric safety requirements. If necessary, please check it for the requirements.
5. Children should be supervised to ensure that they do not play with the appliance.
6. If the supply cord is damaged, it must be replaced by the manufacturer, its service agent or similarly qualified persons in order to avoid a hazard.
7. This appliance can be used by children aged from 8 years and above and persons with reduced physical, sensory or mental capabilities or lack of experience and knowledge if they have been given supervision or instruction concerning use of the appliance in a safe way and understand the hazards involved. Children shall not play with the appliance. Cleaning and user maintenance shall not be made by children without supervision.
8. This appliance is not intended for use by persons (including children) with reduced physical, sensory or mental capabilities, or lack of experience and knowledge, unless they have been given supervision or instruction concerning use of the appliance by a person responsible for their safety.

-
9. The appliance shall be installed in accordance with national wiring regulations.
 10. Recycling



- This marking indicates that this product should not be disposed with other household wastes. To prevent possible harm to the environment or human health from uncontrolled waste disposal recycle it responsibly to promote the sustainable reuse of material resources. To return your used device, please use the return and collection systems or contact the retailer where the product was purchased. They can take this product for environmental safe recycling.
11. Contact authorized service technician for repair or maintenance of this unit.
 12. Do not pull deform. or modify the power supply cord, or immerse it in water. Pulling or misuse of the power supply cord can result in damage to the unit and cause electrical shock.
 13. Compliance with national gas regulations shall be observed.
 14. Keep ventilation openings clear of obstruction.
 15. Any person who is involved with working on or breaking into a refrigerant circuit should hold a current valid certificate from an industry-accredited assessment authority, which authorizes their competence to handle refrigerants safely in accordance with an industry recognized assessment specification.
 16. Servicing shall only be performed as recommended by the equipment manufacturer.
Maintenance and repair requiring the assistance of other skilled personnel shall be carried out under the supervision of the person competent in the use of flammable refrigerants.
 17. Do not operate or stop the unit by inserting or pulling out Die power plug, it may cause electric shock or fire due to heat generation.
 18. Unplug the unit if strange sounds, smell, or smoke comes from it.

- If any parts damage, please contact the dealer or a designated repair shop;
- In case of any damage, please turn off the air switch, disconnect the power supply, and contact the dealer or a designated repair shop;
- In any case, the power cord shall be firmly grounded.
- To avoid the possibility of danger, if power cord is damaged, please turn off the air switch and disconnect the power supply. It must be replaced from the dealer or a designated repair shop.

Instructions For Repairing Appliances Containing R32

General Instructions

- Checks to the area Prior to beginning work on systems containing flammable refrigerants, safety checks are necessary to ensure that the risk of ignition is minimised. For repair to the refrigerating system, the following precautions shall be complied with prior to conducting work on the system.
- Ventilated area Ensure that the area is in the open or that it is adequately ventilated before breaking into the system or conducting any hot work. A degree of ventilation shall continue during the period that the work is carried out. The ventilation should safely disperse any released refrigerant and preferably expel it externally into the atmosphere.

Detection of flammable refrigerants

- Under no circumstances shall potential sources of ignition be used in the searching for or detection of refrigerant leaks. A halide torch (or any other detector using a naked flame) shall not be used.
- The following leak detection methods are deemed acceptable for all refrigerant systems.
- Electronic leak detectors may be used to detect refrigerant leaks but, in the case of FLAMMABLE REFRIGERANTS, the sensitivity may not be adequate, or may need re-calibration. (Detection equipment shall be calibrated in a refrigerant-free area.) Ensure that the detector is not a potential source of ignition and is suitable for the refrigerant used. Leak detection equipment shall be set at a percentage of the LFL of the refrigerant and shall be calibrated to the refrigerant employed, and the appropriate percentage of gas (25 % maximum) is confirmed.
- Leak detection fluids are also suitable for use with most refrigerants but the use of detergents containing chlorine shall be avoided as the chlorine may react with the refrigerant and corrode the copper pipe-work.

Note Examples of leak detection fluids are

- bubble method,
- fluorescent method agents.

If a leak is suspected, all naked flames shall be removed/extinguished. If a leakage of refrigerant is found which requires brazing, all of the refrigerant shall be recovered from the system, or isolated (by means of shut off valves) in a part of the system remote from the leak.

Safety Information

- Install the dehumidifier on flat surface to minimize vibration and or noise.
- Inspect the power cord before use. Never operate the dehumidifier when the power cord or plug is damaged.
- Insert the three-prong plug on the power cord into a matching electrically grounded outlet (115V/ 60 Hz, 16 A at least).
- Do not use an adapter. Never cut off the third prong. Do not use an extension cord.
- Do not operate the dehumidifier in standing water. Keep motor and wiring dry.
- Never immerse the dehumidifier into water or other liquids.
- Do not put the dehumidifier close to heat-generating devices, including flammable or dangerous materials.
- Unplug the power supply before cleaning or storing the dehumidifier. Always grasp the plug (not the cord) to unplug.
- Do not put fingers or other items into air inlet or air outlet.
- Never insert any other objects into the dehumidifier body.
- Do not sit, stand or put heavy objects on the dehumidifier.



Never repair or remove plug and or power cord. Any repairs should be completed by qualified electrician or distributor.

Machine Structure Diagram

Parts Description

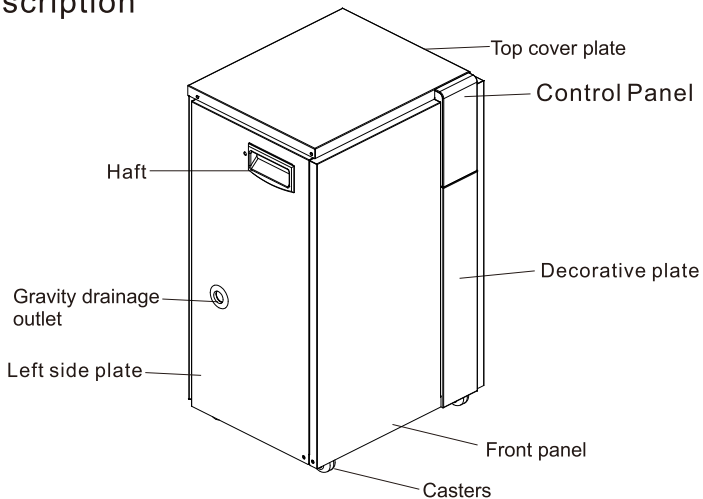

Front view of the machine

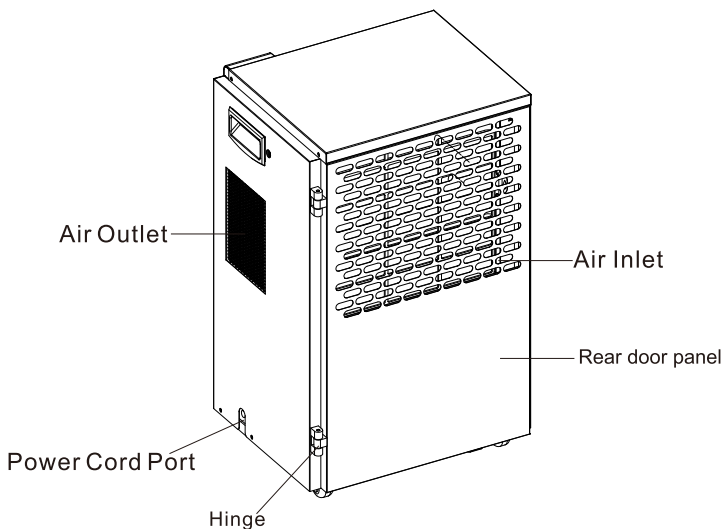



Rear view of the machine

NOTE: There May be slight differences in the model, the actual machine shall prevail.

Operation Instruction

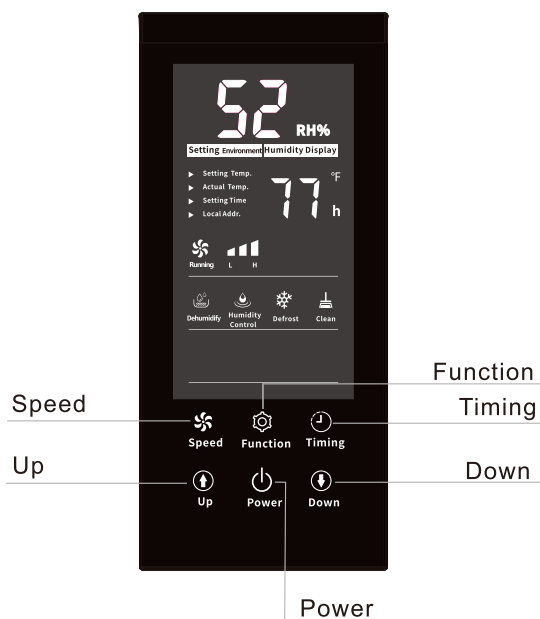
Operation panel





 Used to power on or power off the machine.

 Used to set the humidity and timing value down

 Used for setting the time

 Used to set the humidity and timing value up

 Press to confirm the parameters setting.

 Used to switch to high and low wind speed

Operation Instruction

Operation

Humidity Setting :

In power-on status, press "Up" or "Down" button to enter the humidity setting status: The screen will display the "Setting " and " Humidity Display " icon, the unit icon " RH%" will light up, and the large figure " 52 " will flash to show the humidity value.

In humidity setting status, you can press the "Up" or "Down" button to set the desired humidity within the range of 10-98RH%.

If you press the "function" button or no operation after seconds, you will exit the humidity setting status automatically.

When the setting humidity is 10RH%, the machine will be forced to run at continuous working mode.

Timer Setting:

In power-on status, press the "Timing"button, you will enter the Timer setting mode: The" ► "will point at "Setting Time" function, the time unit "h" will light up and the small figure" 00 " will flash to show the setting value.

In Timer setting status, press "Up" or "Down", you can set a time within the range of 1 to 24 hours, which can be set again if invalid.

If you press the "function" button or no operation after seconds, you will exit the humidity setting status automatically.

If the time it's set to be " 00 ",this is called the invalid time.

Speed Setting:



Two wind speed modes are available for this machine, you can press the " Speed " button to switch to high or low wind speed.



Parameter Query:

In power-on status, press the "Function" button once, you will enter the parameter query status.



The" ► " will point at " Setting Temp. ", the small figure will display the setting temperature and the temperature unit " °F " will light up. Press the " function" buttonl again, you will be able to query the ambient temperature and setting time.

Status Description :

When the fan is delayed, the running symbol "  " will flash, and if the fan is running, the running symbol "  " will be on. otherwise it will be off.

When the compressor is delayed, the dehumidification symbol "  " will flash, and if the compressor is running, the dehumidification symbol "  " will be on, otherwise it will be off.

If the ambient humidity is lower than the setting humidity and the compressor is stopped, the Humidity Control Symbol "  " will flash, otherwise it will be off.

When the fan speed is set to high level, the symbol "  " will light up; when the fan speed is set to low level, the symbol "  " will light up.

When the machine needs to be cleaned, the cleaning symbol "  " will flash, otherwise it is off.

When the machine is defrosting, the defrost symbol "  " will flash, and goes out after finishing the defrosting process.

Power off Memory Function:

After the device is powered on, it will automatically resume the working status before power off.

- If the machine's running before power outage, the machine will automatically enter power-on status, and maintain the previous setting parameters.
- If the machine's shut down before the power outage, then the machine will still be in power-off status.

Defrost Function:

When the dehumidifier is running at a lower temperature, the system will automatically determine whether there is a presence of frost. If any frost exists, it will defrost automatically.



The fan will run at high wind speed and the compressor stops when defrosting, and switch back to the previous setting wind speed after that. The compressor can be restarted then.

Temperature Protection Function:

When the ambient temperature is higher than the Default Highest Temperature (113°F), the system will enter high temperature protection, the small figure on the screen will indicate "HH", and the compressor will stop.

When the ambient temperature is lower than the Default Lowest Temperature 39°F) the system will enter the low temperature protection, the small figure on the screen will indicate " LL ", and the whole machine will stop.

Water Full Protection Function:

When the water tank is full, the machine stops, and the water full indicator light  flashes; when the water full is released, the water full indicator light  goes out, and the machine can be restarted.

Note: The water tank needs to be placed in place normally, otherwise it will also cause the full water protection.

Cleaning Reminder:

If the accumulative running time of the fan is ≥ 30 days, the machine can continue to run, but it will keep prompting the "Cleaning" icon and it will not be able to be removed even re-powered.

In power-off status, press and hold the " speed " button for 3-5 seconds, then the display screen will show up for once, which means the "Clean" prompt has been released, and the fan's previous running time has been cleared.

Special Note:

The compressor features a "3 minutes delay protection" function-While the dehumidifier is powered, the compressor can only start again 3 minutes after its last shutdown.

State Description:

- 1)**Power On:** The fan starts running, and the compressor starts to run after a delay of a few seconds.
- 2)**Power Off:** The compressor stops running immediately, and the fan stops after a few seconds delay.
- 3)To prevent the machine from starting and stopping frequently, there is a 3-minute delay in the start-up interval.

Turn The Dehumidifier Off:

Press the Power Switch to turn the dehumidifier off.

Note: To protect the compressor, the fan will continue to operate for 5 seconds after the dehumidifier has shut off. So please do not disconnect the power cord to force the dehumidifier to stop.

Always use the power button.

Drainage Mode

• Water tank drainage operation instructions

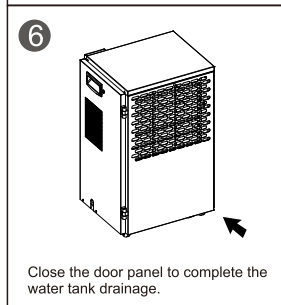
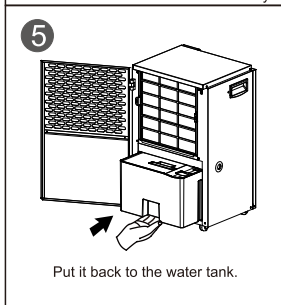
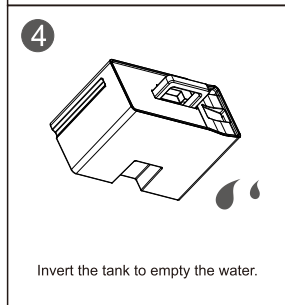
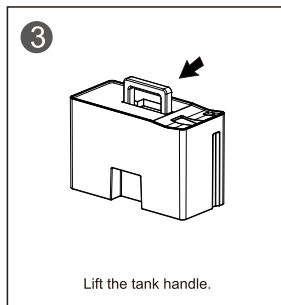
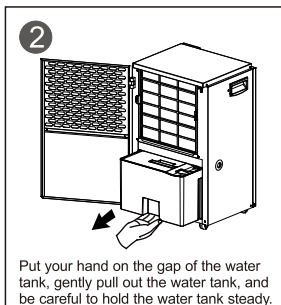
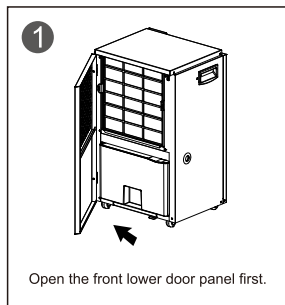

Note:

Do not remove the float ball in the water tank, otherwise the water sensor will not be able to sense the water level normally, resulting in overflow of water.

Clean the water tank only with cold or warm water. Do not use detergent, steel wool, chemically treated dust cloth, gasoline, benzene, thinner or other solvents to prevent water leakage caused by damage to the water tank.

• Operating instructions for water pipe direct discharge

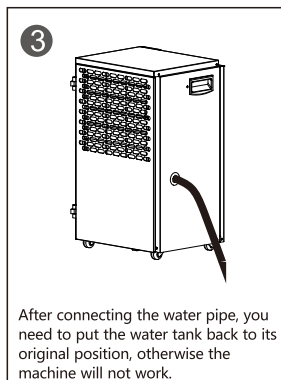
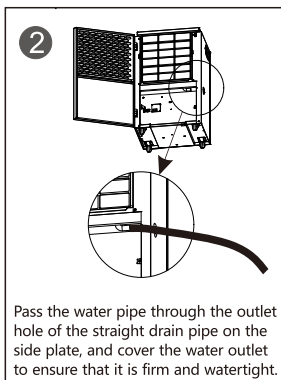
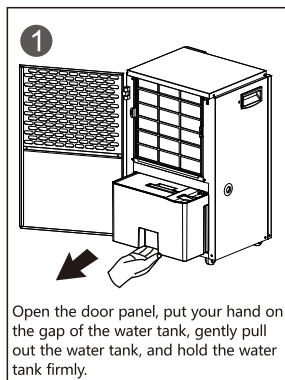

Machine product drawing for reference only, subject to the actual.

Image One: Error Connection example

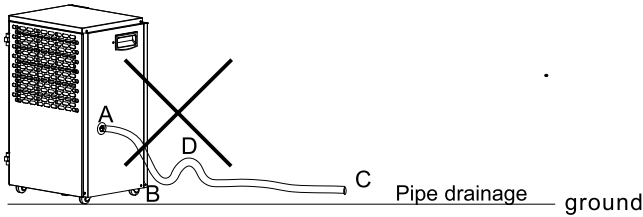

- The water pipe upward arch position D above position B, the inside of the water pipe is prone to air and accumulation, which leads to a smooth discharge through the Pipe.

Image Two: Error Connection example

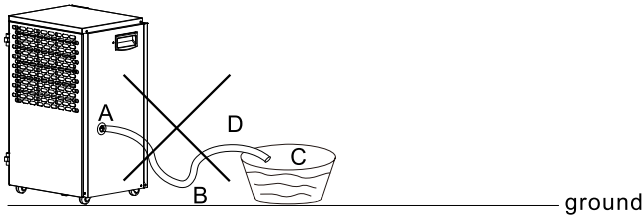

- The water pipe and the water container contact point D is lower than the continuous drain A, but higher than the water pipe at the lowest point B, the inside of the pipe prone to air and water, leading to a smooth discharge of waters through the Pipe. Do not insert pipe outlet C into water.

Image Three: Correct Connection example

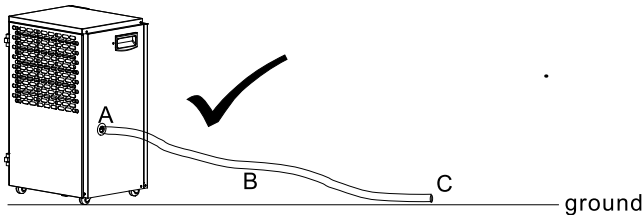

- Water through the continuous drainage port A, from high to low through the B and outlet C smooth discharge, can be used to water containers or discharged into the sewer (outlet C is below the continuous drainage port of 0.33ft above, do not recommend the addition of the original drainage pipe).
- Pipes can be bent and not folded on the ground, but cannot be partially arched.

Tips: The machine has no water full prompting function. When the container is used to receive drainage, attention should be paid to water level.

The product picture of the machine is for reference only, and please refer to the actual product.

Repair and Maintenance

Note:

- Unplug the power cord before servicing and cleaning the product.
- Please use a soft damp cloth to clean the body of the dehumidifier.
- Do not use detergent, scrubbing steel wire, chemically treated dust cloth, gasoline, benzene, thinner or other solvents to clean and wipe the machine.

Clean the filter

-The filter is used to block most airborne dirt, such as dust, smoke, animal dander, mold spores and pollen; Regular inspections and cleaning at least once a month is recommended. When cleaning, you can use a vacuum cleaner or air gun to remove the dirt on the filter screen. If you need to clean it, you can use warm water and mild detergent to rinse it and dry it thoroughly. Do not expose the filter screen to direct sunlight or dry it to prevent deformation of the filter screen.

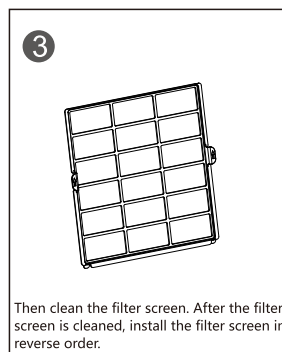
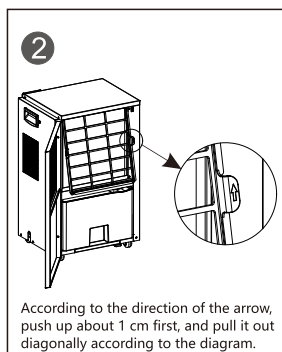
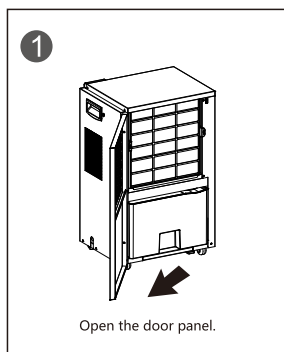

Troubleshooting

Before seeking support from the service team, you can check the following troubleshooting tips:

Fault	Cause	Solution
Dehumidifier not working	<ol style="list-style-type: none"> 1. The fuse is blown 2. Machine failure prompt 	<ol style="list-style-type: none"> 1. Replace the fuse; 2. Please provide the fault code and seek technical support from LUBAIR;
Dehumidifying effect is not obvious	<ol style="list-style-type: none"> 1. Air filter fouling; 2. There are obstacles in the air inlet and outlet of the dehumidifier; 3. The space is not sealed; 4. Refrigerant leakage; 	<ol style="list-style-type: none"> 1. Clean the filter; 2. Remove obstacles; 3. Close the doors and windows, the dehumidification effect of the confined space is more obvious; 4. Please contact LUBAIR for technical support;
Water leakage	<ol style="list-style-type: none"> 1. Machine tilt; 2. The outlet pipe is Blocked; 	<ol style="list-style-type: none"> 1. Adjust the machine and place it horizontally; 2. Remove the access door to remove the foreign matter blocked in the pipe;
Abnormal noise	<ol style="list-style-type: none"> 1. The machine is not placed smoothly; 2. Is the filter blocked; 	<ol style="list-style-type: none"> 1. Relocate the machine to a stable place; 2. Clean the filter;
Humidity always shows "10" (when there is a big difference from the actual humidity)	Humidity sensor failure	<ol style="list-style-type: none"> 1. When the "10" fault phenomenon is always displayed, the humidity is set to 10%RH, and the machine can still continue to run and be used normally; 2. Repair and replace the humidity sensor;
Humidity always shows "99"(when there is a big difference from the actual humidity)	<ol style="list-style-type: none"> 1. The surface of the humidity sensor is condensed or wetted with water; 2. Humidity sensor failure 	<ol style="list-style-type: none"> 1. When the "99" fault phenomenon is displayed all the time, the machine can still continue to dehumidify and operate normally; 2. After the machine has been running for a period of time, when the moisture on the surface of the humidity sensor dissipates, it can automatically remove the fault and resume normal operation; 3. Repair and replace the humidity sensor;

1. When the above fault cannot be eliminated and it is confirmed that repair is required, please contact the LUBAIR support, please do not disassemble the machine for repair without authorization.
2. When the dehumidifier is running or stopped, it is normal to hear the sound of refrigerant circulating.
3. It is normal for hot air to be discharged from the air outlet.

Safety Precautions



1. When using, do not place the dehumidifier on soft, uneven ground to avoid vibration or movement.

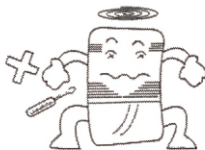

2. Do not use thin rods or hard objects to insert into the fuselage to avoid malfunction or danger.

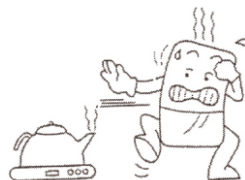

3. When using, please keep the dehumidifier away from heat sources such as heaters and electric kettles to save electricity.



4. When using, please close the doors and windows to achieve the best dehumidification effect.



5. Do not place items before and after the dehumidifier. If the ventilation is blocked, the dehumidification effect will be affected.



6. In case of power failure or long-term non-use, please unplug the power cord.



7. When cleaning the dehumidifier, gently wipe it with a damp cloth, do not directly spray water to clean it.

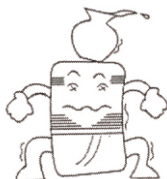

8. Do not place any objects on the dehumidifier.



9. Please clean the filter every two weeks (do not use hot water above 104°F/40°C, alcohol, gasoline, or toluene).



10. During continuous drainage, the drainage pipe must be placed horizontally or downwards, and must not be uneven or entangled.



11. After the filter is cleaned, please do not place it in direct sunlight to dry it to avoid deformation.



12. Before moving or carrying the dehumidifier, please pour out the accumulated water in the water tank.

Service

LUBAIR offers a limited 1-year free warranty on this DE190L dehumidifier, with original proof of purchase (typically you may be only requested to offer the order number or other information to prove a genuine purchase, instead of an invoice) and where a defect has arisen, wholly or substantially, as a result of faulty manufacture, parts or workmanship during the warranty period.

During the warranty period, for the damaged part, we will provide a replacement part if it can be restored to normal use by replacing parts.

The warranty does not apply where damage is caused by other factors, including without limitation:

- Normal wear and tear;
- Abuse, mishandling, accident, or failure to follow operating instructions;
- Exposure to liquid or infiltration of foreign particles;
- Servicing or modifications of the product other than by LUBAIR.

We will try our best to inspect the dehumidifier through photos or videos to troubleshoot and ensure that we can better solve the problem for you. These are our general terms for warranty service, but we always urge our customers to reach out to us with any issue, regardless of warranty terms.

Warranty and Service

If you have an issue with an LUBAIR product, please contact us at LubairServices@outlook.com, and we will do our best to resolve it for you.



Support Hours

24 Hours available

*Please have your order number before contacting customer support.

Product Certification

The product is approved to leave the factory after passing the inspection.
Production date: see the nameplate or barcode of the fuselage





LUBAIR