

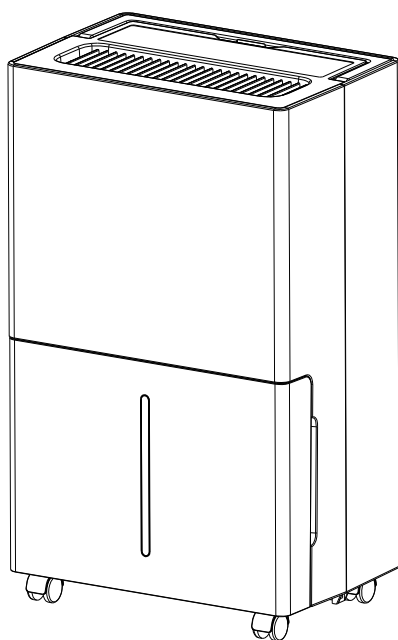

# Home Dehumidifier

## USER MANUAL



Please read the manual carefully before using the product

Model:PD12A



# BEFORE FIRST USE:

Please leave the dehumidifier sitting outside the box for **24 HOURS** before plugging it in.

The dehumidifiers may have been tilted or placed upside down during shipping. Leave The dehumidifier sits for 24 hours so the oil in the compressor can settle from the move, Not doing so can affect the performance or lifespan of the dehumidifier.

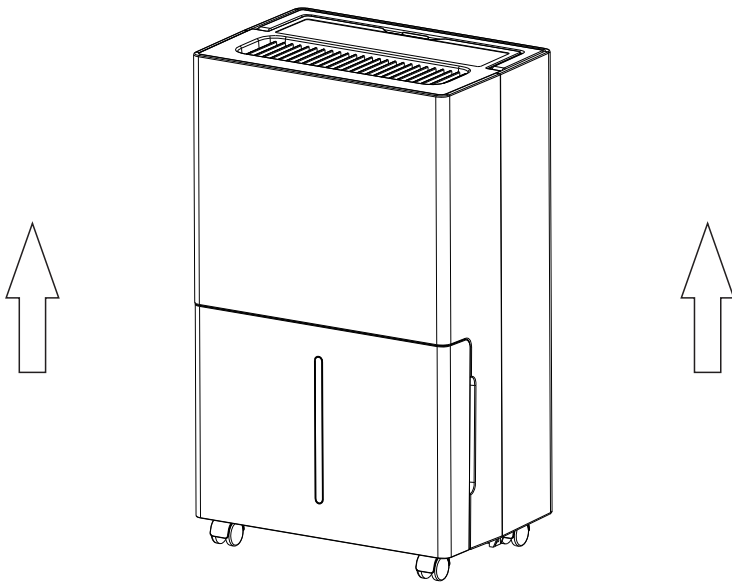

## NOTE:

To continuously improve its products, LUBAIR reserves the right to modify this information without prior notification. For any questions during assembly, please check the instructions on the product page for reference. Or contact our customer service with any questions, comments, or concerns, We are online 24H for you. Thank you for using LUBAIR products in your home!

Made in China

## ■ WARNING

- ▶ Manufacturer recommendations.
- ▶ The equipment should be stored in a room without ignition source(include fire, Working gas equipment,Working electric heater).
- ▶ Please don't puncture or burn it.
- ▶ Note that refrigerants may not contain odors.
- ▶ Refrigerant must be added at the specified location.
- ▶ This product can not be disposed of with other household garbage, Please classify it correctly, And put it in places where it can be recycled to promote sustainable use of resources.
- ▶ The equipment shall be installed in accordance with national wiring requirements.
- ▶ If the power cord is damaged. It must be replaced by the manufacturer, agent or professional.
- ▶ The device should be used by worker under the guidance of the professional.
- ▶ Keep out of infants, children, and the elderly



Caution,risk of fire

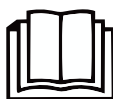

Warning

## ■ CAUTION

- ▶ Do not place the dehumidifier near a heater, do not use the dehumidifier near flammable gas or combustibles, such as gasoline, benzene, thinner, etc.
- ▶ Do not use the proudct if the power cord is broken or damaged.
- ▶ Do not use the socket if it is oose or damaged.
- ▶ Do not modify the length of the power cord length or share the outlet with other dehumidifiers.
- ▶ Never try to take apart or repair the dehumidifier by yourself.
- ▶ Do not place a heavy object on the power cord and make sure that the cord is not compressed.
- ▶ Do not place flower vases or other water containers on top of the dehumidifier.
- ▶ Do not operate or turn off the dehumidifier by plugging in or unplugging the dehumidifier. Use the control panel instead.
- ▶ Make sure to turn off and unplug the dehumidifier before cleaning.
- ▶ Turn off and disconnect the power when not using the dehumidifier for a long time.
- ▶ Use a piece of soft cloth to clean. Do not use wax, thinner, or a strong detergent.
- ▶ Do not climb on or sit on the dehumidifier.

---

# Welcome

Thanks for choosing LUBAIR dehumidifier!

LUBAIR is dedicated to keeping people healthy, comfortable and more enjoyable by offering quality appliances ranging from dehumidifiers to ice makers, and more. From breathing easier in your office to upgrading your kitchen appliances, we hope LUBAIR could help you every step of the way.

**READ THIS MANUAL INSTRUCTION CAREFULLY BEFORE USING THE UNIT.  
PLEASE KEEP THIS FOR FUTURE REFERENCE.**

LUBAIR PD12A home dehumidifier reducing humidity to comfortable levels in a short period of time. This dehumidifier has a sturdy housing to withstand harsh environments, is safe and easy to use, guarantees long-term use and easy maintenance, plus we use a copper tube condenser and high quality and accurate sensors, it will be more effective and last longer.

Before plugging in your new dehumidifier, we suggest that you read this user manual as it contains important safety information, operation instructions, troubleshooting, maintenance tips, and warranty information to ensure the reliability and longevity of your dehumidifier.

## We're always just an email away

To access customer support, please email to [LubairServices@outlook.com](mailto:LubairServices@outlook.com) with your purchase order.

Thank you again!

---

---

# Table of Contents

Precautions for Use .....	1
Parts Description .....	2
Control Panel.....	3
Operation Instructions.....	4
Cleaning and Maintenance.....	12
Troubleshooting.....	13
Service.....	16

## Statement

The graphics and functions provided in this manual maybe not the same as the actual product. The model shown in this manual is only for reference. Please install and operate the machine according to the actual situations. The company reserves the right to interpret relevant terms.

---

## Precautions for Use

### Safety notes:

For your safety, please read this manual carefully and keep it for future reference. This product is for home use only. Please install and use the product according to the operations in this manual.

- Before cleaning the dehumidifier, please turn off the machine and unplug it from the power source.
- Please do not place the machine near heat or flammable goods.
- Do not put any sticks or your fingers into the air inlet or outlet.
- Please always place the machine on a flat ground, rather than uneven or sloping ones.
- Do not spray water, insecticides or flammable liquids on the machine.
- Please do not place the machine in a confined or narrow space.
- If the power cord is damaged, please contact a technician approved by the company to replace it.
- In Dry Mode, please keep the clothes at least 15.7 inches away from the air outlet to prevent the water entering the machine to cause damages.
- Please make sure the machine power wiring is installed in accordance with national wiring rules. The power cord should be connected to a reliable external naught wire.
- The fixed wiring connected to the machine must be equipped with an all-pole disconnect device (air switch) with a contact distance of at least 0.118 inch.
- The specification of the fuse: 3.15A.
- Please use this dehumidifier in an environment with the temperature range between 41°F/5°C and 95°F/35°C.
- When using the dehumidifier, please keep other surrounding objects at least 7.9 inches/20cm away from the machine. As shown in the picture:

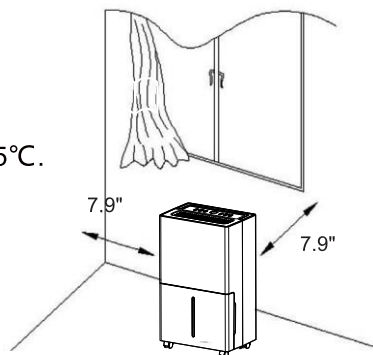

# Parts Description

## Front

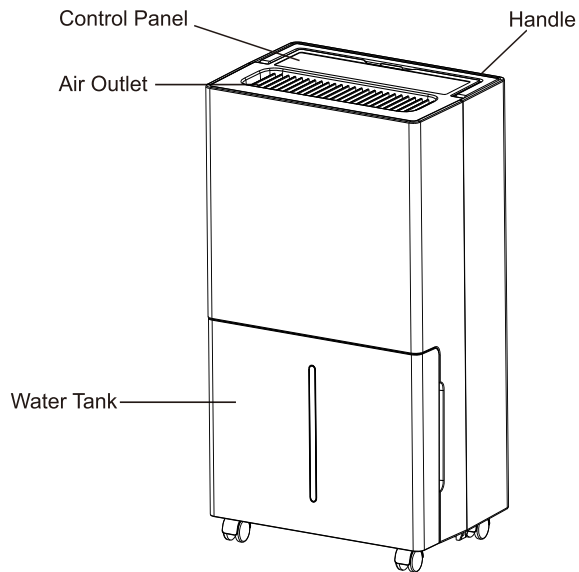

## Back

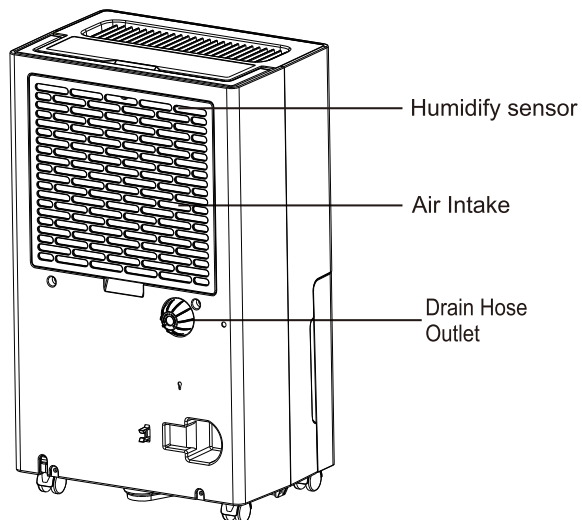



## 1.Control Panel

DISPLAY PANEL

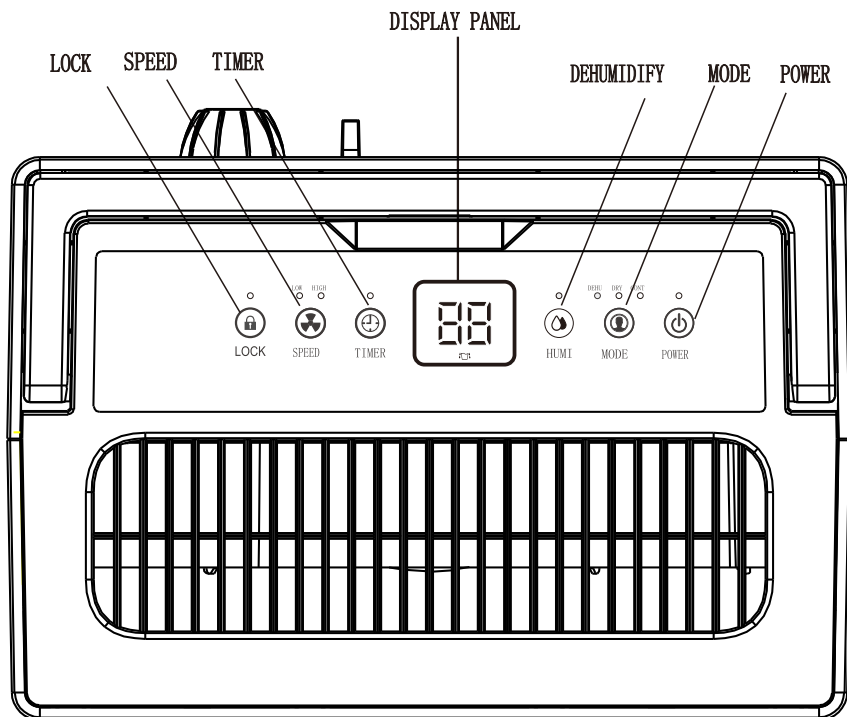

## 2.Setting

### Mode Setting

There are DEHU Mode, DRY Mode, CONT Mode.

After the machine is turned on, press the "MODE" button to switch the working modes. Each time pressing the button, the machine will cycle through the DEHU mode, the Clothes-Dryer mode, and the Continuous Dehumidifying mode.

#### Notices:

In the DEHU Mode: Both the humidity and fan speed are settable.

In the DRY Mode: Both the humidity and fan speed are not settable.

In the CONT Mode: The fan speed is settable, while the humidity is not settable.

### Humidity Setting:

The humidity level can be set within the range of 30% RH to 80% RH in 5% increments.

-When the machine starts working, it will first automatically detect and show the room humidity. In the dehumidification mode (not settable under the other modes), press the "HUMIDITY" button to change the humidity selection, each time in 5% increments. The number indicator "88" will keep flashing and show the set humidity. Once you have settled the humidity you want, please stop operating and wait for 5 seconds, the number indicator "88" will stop flashing and turn to show the actual room humidity instead.

-When the humidity level falls below the set humidity, the dehumidifier will automatically stop working, while the humidity level exceeds the set humidity, it will automatically start working again.

-When the humidity level is set at 30% RH, the dehumidifier will turn to work in the continuous dehumidifying mode.



### Timer Setting:

The time setting is used to set a time for the machine to automatically turn on or turn off.

1. When the machine is turned on, the time setting is used for auto turn-off; When the machine is turned off, the time setting is used for auto turn-on.
2. Press the "TIMER" button to select the timer, each time in 1-hour increments. You can set the timer up to 24 hours. It will start to do the countdown when the setting is finished.
3. If the time is set at "88", this is called the invalid time which means the time setting is invalid. Once the time setting is succeeded, the light "⌚" will light up, and the led screen will keep showing the setting time for seconds, then turn back to show the current room humidity.

---

## Lock Setting

When the machine is turned on, press and hold the LOCK button " " for 3 seconds, the control panel will be locked together with the other function buttons. To unlock the control panel, press and hold the LOCK button " " again for 3 seconds.

## Speed Button

The speed button is used to control the fan's speed, it can be switched to the high-speed mode or low-speed mode.



\*Notice:

The high-speed mode will gain the moisture removal effect, while the low-speed mode will be much quieter, please choose your preferred speed mode accordingly.

## Memory Function

If a power interruption occurs when the machine is in the turned-on state and working normally, it will restore the turned-on state directly and remain the previous parameters settings after the power is recovered.

## Overflow Protection

When the water in the water tank reaches full, the machine will turn off automatically. The indicator light " " will start flashing, and the buzzer will alarm for seconds. After emptying the water from the water tank, the indicator light " " will turn off, and the machine will start to work again.

\*Notice:

Please make sure the machine is placed on a flat surface, or it may also cause the alarm and protection when the water is not full.

---









## Auto Defrost Function

When the machine is running at a very low temperature, the system will automatically determine whether there is a presence of frost. If the machine determines there is a presence of frost, it will start to defrost automatically.

## Defrost Action

The fan will run at the high-speed mode while the compressor will stop working.  
Defrost Status Display In the defrosting status, the power button "  " will keep flashing.

## 3.Display Status Description

- ▶ After the machine is settled up an electric circuit, the "POWER" button "  " will light on which means the machine is powered on and stays at the Standby (Turned- off) status.
- ▶ Timer indicator "  ": If the timer is set up properly, the indicator will turn on, when the timer is not set up properly the indicator light will turn off.
- ▶ The lighting button indicators - the mini round lights: When using the light function the indicator will turn on, and turn off if the function is not used.
- ▶ High-speed indicator "  " : If you set the machine to high-speed fan mode, the indicator will turn on.
- ▶ Low-speed indicator "  " : If you set the machine to low-speed fan mode, the indicator will turn on.
- ▶ Dehumidifying mode indicator "  " : When the machine starts to dehumidify, the indicator will turn on. When the room environment humidity reaches the set humidity, the indicator will start flashing. Otherwise, it will be off.
- ▶ Clothes-Dryer indicator "  " : When the Clothes-Dryer mode is selected, the indicator will turn on, otherwise it will be off.
- ▶ Continuous Dehumidifying mode indicator "  " : When the Continuous Dehumidifying mode is selected, the indicator will turn on, otherwise it will be off.
- ▶ Water full light indicator "  " : When the water tank is full of water, the indicator will start flashing.
- ▶ When the machine is working properly, the data "  " on the display panel will be the humidity value.

---

## 4. Instructions for Drying Clothes

The dehumidifier can be used for drying clothes in rainy weather.

### **Step 1.**

Hang the washed clothes in a small space such as a cloakroom, bathroom, or storage room.

Notice: Keep the unit away from the water drip from the washed clothes.

### **Step 2.**

Open the dehumidifier and set the humidity level at 30% RH. It is suggested to let the air outlet of the dehumidifier blow air to the clothes directly.

1. The drying effect will vary from the thickness of clothes, the number of clothes, and the size of the drying room. Theoretically, the effect will be better when clothes are few, thin and the room is small.
2. The drying process would take 3 - 8 hours, thus, setting the machine to the continuous drainage mode is more suggested when drying clothes.

# 5.Faults and Solutions

Problems	Analysis of Causes	Solutions
Humidity always shows "25% RH" but there is a big difference from the actual humidity.	Does the humidity sensor fail?	Set the humidity to 30% RH and check if the dehumidifier can work normally. If it does, the machine is in a good condition.
		Repair or replace the humidity sensor.
Humidity always shows "99% RH" but there is a big difference from the actual humidity.	Is there some water on the surface of the humidity sensor?	The dehumidifier can work normally. The moisture removal effect is not affected.
		Please keep the machine working for a while to remove the water on the humidity sensor surface. The machine will work normally when the water is removed.
		Repair or replace the humidity sensor.

If the malfunctions still exist, please don't hesitate to contact LUBAIR Customer Service at [LubairServices@outlook.com](mailto:LubairServices@outlook.com) for help.

**Notice:**

- 1. Do not block or block the air outlet,Or place something above the air outlet,and the air inlet should not be too close to the wall. It is recommended to be 11.81 inches away from the wall.
- 2.Do not unplug the power cord directly to turn off the machine.

# 6.Empty the Tank or Bucket

There are two ways to remove collected water.

## Use the Bucket

When the water tank is already full, the Full Tank Alert indicator will light up,the dehumidifier will automatically shut down until the tank has been emptied and placed back to the unit.

## Ways to Empty the Water Tank

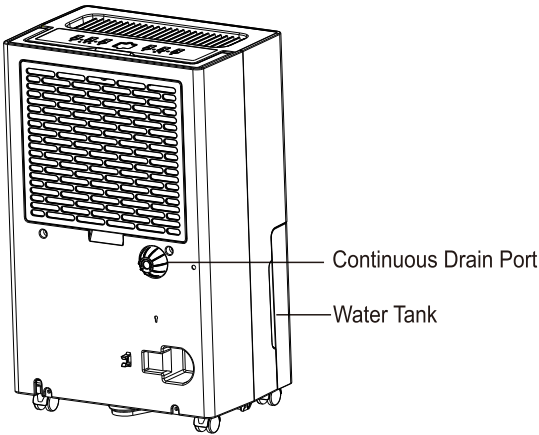
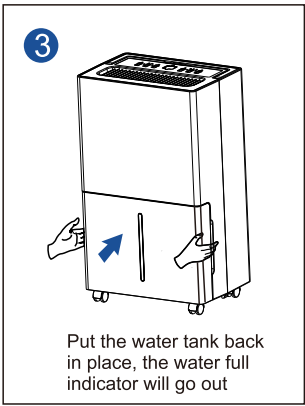
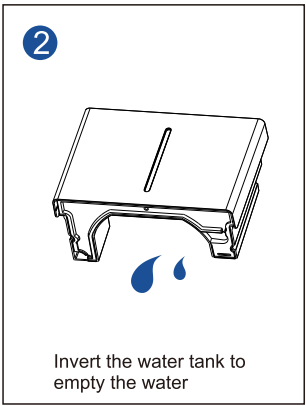
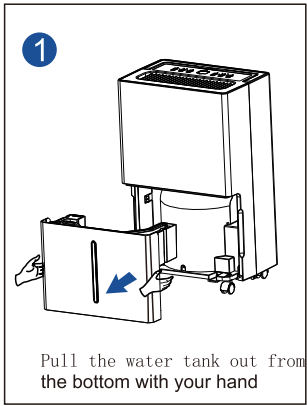

---

Note:

- Do not remove the float from the water tank. If the float in the water tank is removed, the sensor may not be able to determine the water level stored in the tank properly that may lead to water overflow leak from the water tank.
- If the water tank is dirty, just use cold water or warm water to clean it. Do not use detergent, steel wool, chemically treated dust cloth, gasoline, benzene, thinner or other solvents. Otherwise, it may damage the water tank and cause it to leak.
- When placing back the water tank, use your hands to press the tank back in its place. If the water tank is not placed properly, sensors or protections from water overflow may not operate as expected.

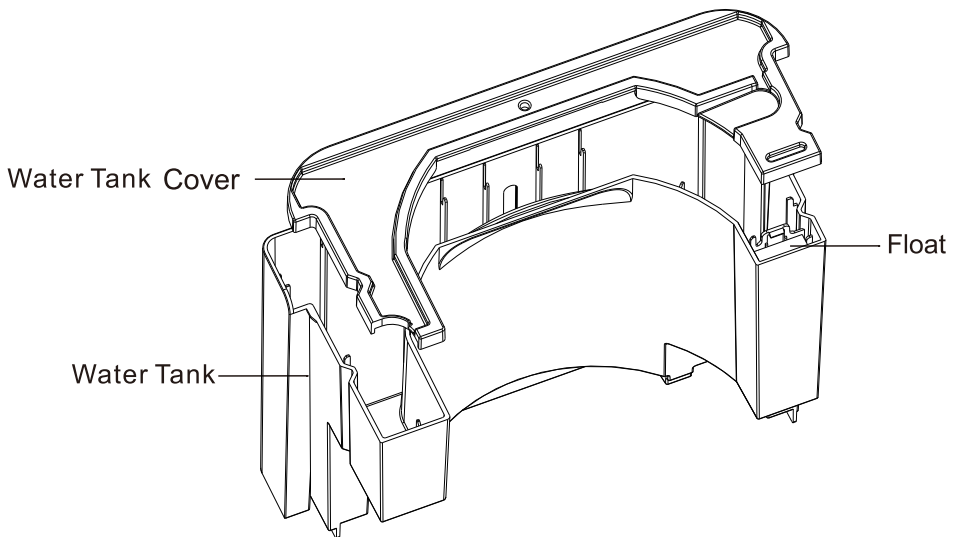



## 7. Continuous Drainage

Remove the power supply and remove the water tank. Open the drain cover, remove the rubber plug, insert the water pipe into the continuous drain, then push the water tank back into the body, connect the power supply, start the operation, and ensure that the water tank is installed in place, you can carry out the continuous drainage function.

Do not bend the drain hose. (Note: The diameter of the continuous drain port is 5/8 inch.)

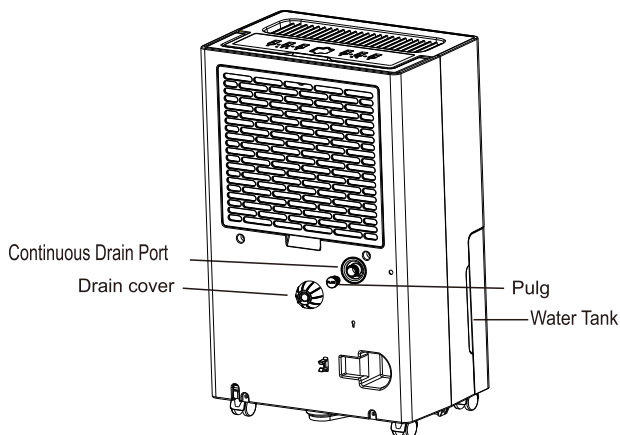
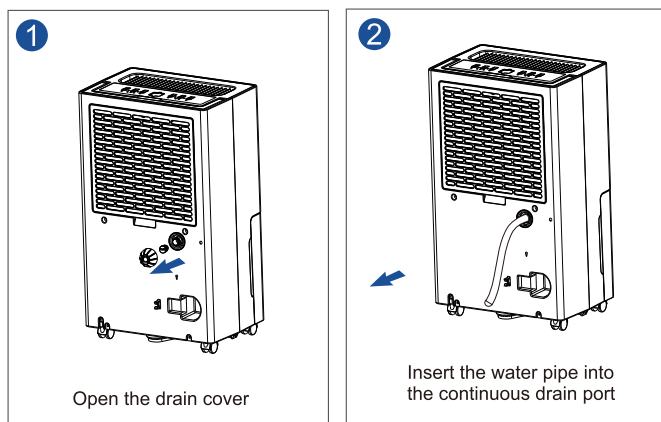

## Cleaning and Maintenance

### **⚠ WARNING:**

Turn the dehumidifier off and remove the plug from the power source before cleaning

### **A- Cleaning the dehumidifier body**

Please use only a soft and a bit wet textile or cloth to clean it.

### **B- Cleaning filter**

- ❶ Pull out the filter.
- ❷ Clean the filter: use a vacuum cleaner to gently remove the dust from the surface of the filter. if the filter is very dirty, wipe it with warm water and a mild detergent and dry it completely.
- ❸ Slowly insert the filter back into the fuselage.

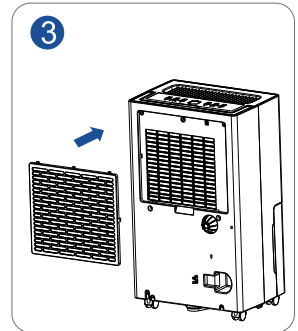
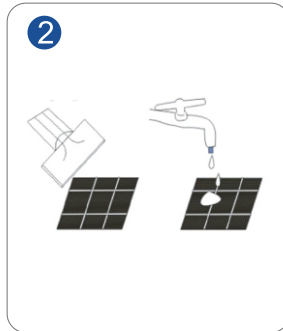
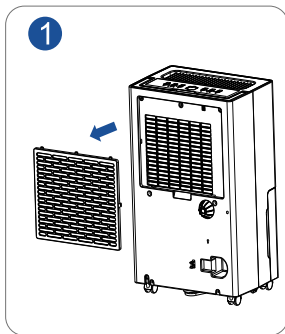

### **C-Dehumidifier Storage**

When you want to store the dehumidifier because you don't use it for a long time.

Please pay attention to the following steps:

1. Empty the water in the water tank.
2. Roll up the power cord and tie it up.
3. Clean the filter.
4. Place the machine in a cool and dry environment.

## Troubleshooting

Check the information below for troubleshooting the common problems you may encounter in the future. These abnormal conditions that are not faults caused by manufacturing process or material defects.

If the malfunctions still exist, please feel free to contact LUBAIR customer service for help.

Problems	Possible Causes	Troubleshooting
Dehumidifier does not work	The power cord is unplugged.	Make sure that the unit's plug is inserted properly into the power outlet.
	Is the full tank indicator flashing? (The tank is full or it is in a wrong position.)	Empty the water in the water tank and then reposition the tank.
	Is the room temperature above 95°F (35°C) or below 41°F (5°C).	The machine cannot work in an overheat or cold environment. It will automatically shutdown to protect itself.
	Is the room temperature between 41°F (5°C) and 68°F (20°C) ?	When running under lower ambient temperature, the machine will automatically defrost, it is a normal phenomenon. Wait until the defrost process finish, it will restart dehumidifying again.
	The dehumidifier is in the defrosting process.	It is normal the compressor ceases while defrosting process. Wait until the defrost process finish, it will restart dehumidifying again.
	Does the room humidity is lower than or reach the preset humidity level? (The room humidity has reached the preset humidity level, the dehumidifier enters into Standby Mode and the LCD and indicators will flash.)	Please set the humidity 5% lower than the room humidity or set the humidity to 30% RH.
	There is prevent frequent start function in the machine. Does the machine stop working just now?	Please wait for more than 3 minutes.
	Room humidity is low.	The machine is designed to work in the humidity range of 30% RH to 80% RH. It will not work if the humidity is not within this range.

Dehumidifier does not dry the air as it should	The air filter is dirty.	Clean the air filter.
	Is the air inlet or air outlet obstructed?	Remove the obstruction from the air inlet or outlet.
	The dehumidifier size is too small for application.	Increase the quantity of dehumidifier. Or change a higher capacity dehumidifier.
	Poor air circulation.	Please leave about 7.9inch(20cm) around the product.
	Did not allow enough time to remove the moisture.	Allow enough time to remove the moisture. When first installed, allow at least 3-4 days to maintain the desired RH.
	The room has not been sealed properly.	Check that all doors, windows and other openings are securely closed.
	The room temperature is too low or the ambient temperature is below 41 °F (5°C) (The machine will not work or it dehumidifies very slowly in low temperature).	Please wait the temperature rises above 41 °F (5°C) or higher.
The dehumidifier makes loud noise when operating	The dehumidifier is not positioned level.	Move the machine to a horizontal position.
	Is there blocking around the air inlet? The air filter is clogged.	Clean up the dirt on the air inlet and outlet.
	Is the filter installed correctly?	Please check to see if the filter package is removed and it is installed properly.
Dehumidifier operates continuously	Check if the dehumidifier is in CONTINUOUS MODE.	Don't set the humidity too low. Typically, 40-50% are good settings to use.
	Room humidity is too high.	Change humidity settings or replace the machine with a higher-capacity dehumidifier.
	Doors and windows are open.	Ensure that all doors, windows and other openings are closed.

---

Overflow of water on floor	The connection between the hose and port may be loose.	Connect the hose with the drain outlet tightly.
	The water tank is not installed properly.	Re-install the water bucket properly.
	The float of the water tank has sunk.	Move the float and make sure it can swing freely.
	The magnet on the float has come off.	Put the magnet in right position.

## Service

LUBAIR offers a limited 1-year free warranty on this PD12A dehumidifier, with original proof of purchase (typically you may be only requested to offer the order number or other information to prove a genuine purchase, instead of an invoice)

and where a defect has arisen, wholly or substantially, as a result of faulty manufacture, parts or workmanship during the warranty period.

During the warranty period, for the damaged part, we will provide a replacement part if it can be restored to normal use by replacing parts.

The warranty does not apply where damage is caused by other factors, including without limitation:

- Normal wear and tear;
- Abuse, mishandling, accident, or failure to follow operating instructions;
- Exposure to liquid or infiltration of foreign particles;
- Servicing or modifications of the product other than by LUBAIR.

We will try our best to inspect the dehumidifier through photos or videos to troubleshoot and ensure that we can better solve the problem for you.

These are our general terms for warranty service, but we always urge our customers to reach out to us with any issue, regardless of warranty terms.

### Warranty and Service

If you have an issue with an LUBAIR product, please contact us at [LubairServices@outlook.com](mailto:LubairServices@outlook.com), and we will do our best to resolve it for you.



#### Support Hours

24 Hours available

\*Please have your order number before contacting customer support.

#### Product Certification

The product is approved to leave the factory after passing the inspection.

Production date: see the nameplate or barcode of the fuselage







**LUBAIR**