

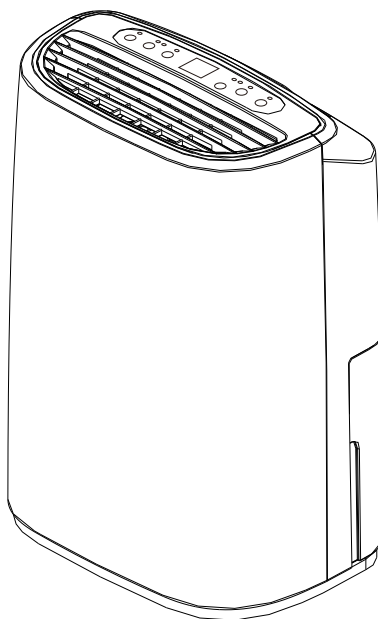

Home Dehumidifier User Manual



Please read this user manual before operating and save for future reference.

Model: PD161A

■ WARNING

- ▶ Manufacturer recommendations.
- ▶ The equipment should be stored in a room without ignition source(include fire, Working gas equipment,Working electric heater).
- ▶ Please don't puncture or burn it.
- ▶ Note that refrigerants may not contain odors.
- ▶ Refrigerant must be added at the specified location.
- ▶ This product can not be disposed of with other household garbage, Please classify it correctly, And put it in places where it can be recycled to promote sustainable use of resources.
- ▶ The equipment shall be installed in accordance with national wiring requirements.
- ▶ If the power cord is damaged. It must be replaced by the manufacturer, agent or professional.
- ▶ The device should be used by worker under the guidance of the professional.
- ▶ Keep out of infants, children, and the elderly



Caution,risk of fire



Warning

■ CAUTION

- ▶ Do not place the dehumidifier near a heater, do not use the dehumidifier near flammable gas or combustibles, such as gasoline, benzene, thinner, etc.
- ▶ Do not use the proudct if the power cord is broken or damaged.
- ▶ Do not use the socket if it is oose or damaged.
- ▶ Do not modify the length of the power cord length or share the outlet with other dehumidifiers.
- ▶ Never try to take apart or repair the dehumidifier by yourself.
- ▶ Do not place a heavy object on the power cord and make sure that the cord is not compressed.
- ▶ Do not place flower vases or other water containers on top of the dehumidifier.
- ▶ Do not operate or turn off the dehumidifier by plugging in or unplugging the dehumidifier. Use the control panel instead.
- ▶ Make sure to turn off and unplug the dehumidifier before cleaning.
- ▶ Turn off and disconnect the power when not using the dehumidifier for a long time.
- ▶ Use a piece of soft cloth to clean. Do not use wax, thinner, or a strong detergent.
- ▶ Do not climb on or sit on the dehumidifier.

BEFORE FIRST USE:

Please leave the dehumidifier sitting outside the box for **24 HOURS** before plugging it in.

The dehumidifiers may have been tilted or placed upside down during shipping. Leave The dehumidifier sits for 24 hours so the oil in the compressor can settle from the move, Not doing so can affect the performance or lifespan of the dehumidifier.

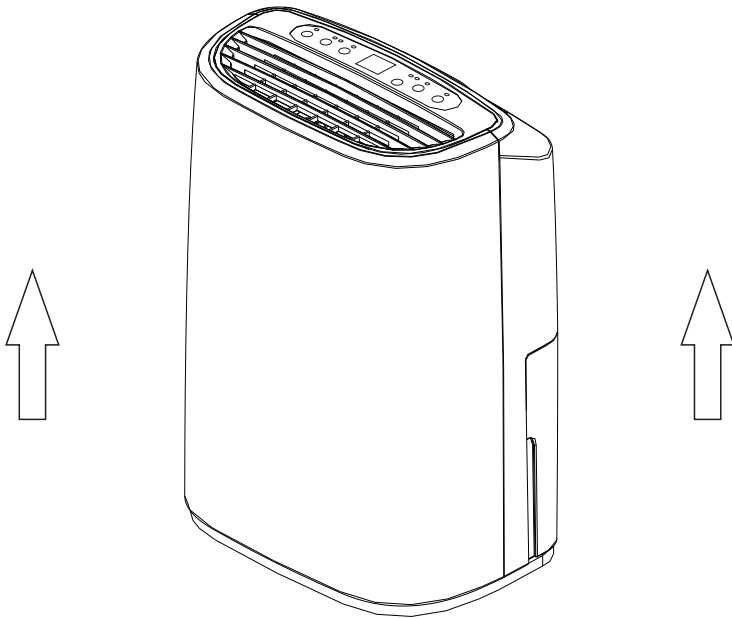

NOTE:

To continuously improve its products, ANDTE reserves the right to modify this information without prior notification. For any questions during assembly, please check the instructions on the product page for reference. Or contact our customer service with any questions, comments, or concerns, We are online 24H for you. Thank you for using ANDTE products in your home!

Made in China

Welcome

Thanks for choosing **ANDTE** dehumidifier!

ANDTE is dedicated to keeping people healthy, comfortable and more enjoyable by offering quality appliances ranging from dehumidifiers to ice makers, and more. From breathing easier in your office to upgrading your kitchen appliances, we hope **ANDTE** could help you every step of the way.

**READ THIS MANUAL INSTRUCTION CAREFULLY BEFORE USING THE UNIT.
PLEASE KEEP THIS FOR FUTURE REFERENCE.**

ANDTE PD161A home dehumidifier reducing humidity to comfortable levels in a short period of time. This dehumidifier has a sturdy housing to withstand harsh environments, is safe and easy to use, guarantees long-term use and easy maintenance, plus we use a copper tube condenser and high quality and accurate sensors, it will be more effective and last longer.

Before plugging in your new dehumidifier, we suggest that you read this user manual as it contains important safety information, operation instructions, troubleshooting, maintenance tips, and warranty information to ensure the reliability and longevity of your dehumidifier.

We're always just an email away

To access customer support, please email to AndteServices@outlook.com with your purchase order.

Thank you again!

Table of Contents

Important Safety Instructions..... 1

Parts Identification..... 2

Operation Instructions..... 3

Care & Cleaning..... 9

Troubleshooting..... 11

Safety Precautions..... 13

Service..... 14

Important Safety Instructions

To prevent injury and property damage, the following instructions must be followed when using the dehumidifier.

Warning

1. Do not place the dehumidifier near a heater. Do not use the dehumidifier near flammable gas or combustibles, such as gasoline, benzene, thinner, etc.
2. The dehumidifier shall be installed in accordance with national wiring regulations.
3. Always plug into a grounded outlet properly.
4. If the supply cord is damaged, it must be replaced by the manufacturer, its service agent or similarly qualified Persons in order to avoid a hazard.
5. Do not use the socket if it is loose or damaged.
6. Do not modify power cord length or share the outlet with other dehumidifiers.
7. Never try to take apart or repair the dehumidifier by yourself.
8. Do not place a heavy object on the power cord and make sure that the cord is not compressed.
9. Do not place flower vases or other water containers on top of the dehumidifier.
11. Do not operate or turn off the dehumidifier by plugging in or unplugging the dehumidifier. Use the control panel instead.
12. Disconnect the power if strange sounds, odors, or smoke come from the dehumidifier.
13. Do not operate the dehumidifier with wet hands.
14. Make sure to turn off and unplug the dehumidifier before cleaning.
15. Do not clean the dehumidifier with water. If water enters the dehumidifier, turn off the dehumidifier immediately.
16. Care should be taken when using the dehumidifier in a room: infants, children, and the elderly.

Caution

1. Hold the plug by the head when taking it out.
2. Turn off and disconnect the power when not using the dehumidifier for a long time.
3. Install the dehumidifier properly on a floor, table, or shelf that is level and strong enough to support it when the water bucket is full.
4. Close all doors, windows and other outside openings to the room.
5. Use a soft cloth to clean. Do not use wax, thinner, or a strong detergent.
6. Be sure to replace the bucket properly after emptying to prevent water from dripping on the floor.
7. Do not climb on or sit on the dehumidifier.
8. Never insert your finger or other foreign objects into grills or openings. Take special care to warn children of these dangers.

Parts Identification

Control Panel

Outlet

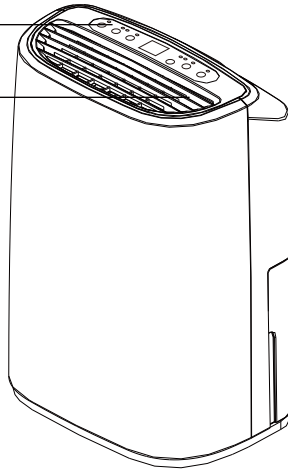

Handle

Filter

Air inlet (with filter)

Humidity sensor

Water tank

Drain Hose Outlet

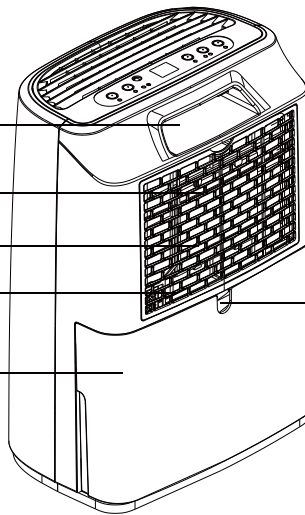

NOTE: Do not cover or block the air inlet or outlet.

Operation Instructions

1. Position Your Dehumidifier Properly

- Place the dehumidifier on a smooth, level floor that is strong enough to support the dehumidifier with a full bucket of water.
- To maintain efficiency, operate the dehumidifier in an enclosed area. Keep nearby doors and windows closed.
- Maintain a minimum clearance of 20 cm (7.9 inches) on the sides and back of the dehumidifier and 40 cm (15.75 inches) on the top of the dehumidifier to allow for proper air circulation.
- The functioning temperature range is between 5°C (41°F) and 35°C (95°F).
- Any time the dehumidifier is placed on its back or side, it must be allowed to stand upright for 24 hours before plugging in to avoid damage to internal components.

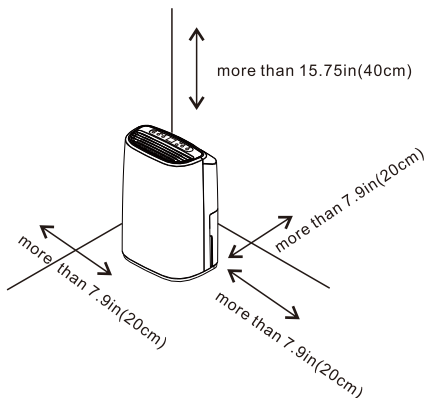

2. Understand the Control Panel



Power Button and Indicator

Press the POWER button once to turn on/off the dehumidifier. When the dehumidifier has been turned off, the LCD screen turns blank.

The indicator above the POWER button will flash when the compressor has not kicked on. And it will turn to solid green when the compressor kicks on.

Note: When the POWER button indicator flashes, it typically means

- 1) The set humidity is not 3% lower than the room humidity;
- 2) The dehumidifier has dropped the room humidity level down to the set-point;
- 3) The dehumidifier is under the 3-minute delay protection state (*See details on Page 6 “3-Minute Delay Protection Mechanism”).



Timer Button and Indicator

Use this TIMER button to set the timer function. The indicator light will turn on when the timer function is active. When the timer function is enabled, pressing the TIMER button once could check the time remaining.

Defrost Indicator

The DEFROST indicator light will illuminate when the frost has accumulated on the interior of the dehumidifier. The dehumidifying function will cease until the frost has melted. And the defrosting indicator will go off when the dehumidifier has stopped defrosting. When defrosting is complete, the dehumidifier will restart to dehumidify automatically.

Note: The frequent defrost process indicates that the ambient temperature is too cold. Therefore, if the room temperature is lower than 60°F, please consider adding heat to promote proper drying.

Defrost Indicator

The FULL indicator light will illuminate when the bucket is full of water, as a reminder to empty the water bucket. Empty the bucket and re-install the bucket properly to resume regular functioning.

LCD Screen

- When no operation on the control panel, the LCD displays the inlet air humidity percentage value which is similar to the room humidity level. The room humidity reading is accurate within $\pm 5\%$.
- When you are setting the target humidity level, the LCD will turn to display the humidity setting value and flash.
- When you are setting the timer, the LCD will turn to display the timer setting value and flash.
- When the dehumidifier detects any system errors, the LCD will display an error code.



Setting Button

- Keep pressing the SETTING button to adjust the set humidity.
- The humidity can be set between 30-80% in 5% increments. For drier air, set the humidity to a lower number. For damper air, set the humidity to a higher number.



Speed Button and Indicator Light

Press the SPEED button to set the fan speed to low or high. If the HIGH indicator light is on, the fan is set to high speed. If the LOW indicator light is on, the fan is set to low speed.

3. General Operation

Note: This dehumidifier may have been tilted or placed upside down during shipping. To ensure this dehumidifier works properly, please ensure this dehumidifier is upright for at least 24 hours before initial use.

Step 1: Plug the power cord into a properly grounded 110-120 volt AC outlet.

- Once plugged in, the control panel will light up for a second and then turn off. You'll need to press the POWER Button to turn the dehumidifiers on.
- If the "FULL" indicator is on, remove the bucket and re-install it properly.
- If the "FULL" indicator is on, remove the bucket and re-install it properly.

Step 2: Press the POWER button to turn the dehumidifier on. The dehumidifier will run in the default setting of 30% set humidity at low fan speed. The LCD screen displays the room humidity reading.

Step 3: To set your desired humidity, press the SETTING button repeatedly to choose a value between 30%-80% in increments of 5%. After selecting the desired humidity percentage value, please wait for 5 seconds until the big font digital number turns to statically display the room humidity level.

- The set humidity is recommended to be at least 10% lower than the room humidity level.
- If the set humidity level is 30, the dehumidifier will run continuously in CONTINUOUS Mode.
- Set the target humidity level between 35-80, the dehumidifier will run in Humidstat Mode. In Humidstat Mode, the dehumidifier will automatically STOP or RESTART based on the set-point to maintain the room humidity level within the range of $\pm 3\%$ of the set-point. For example, if the set humidity level is 50, the dehumidifier will stop dehumidifying when the room humidity reaches 47, and then restart when the room humidity raises back to 53.
- The dehumidifier will automatically stop either when the water bucket is full or when the room humidity is down to the set-point. (*See details on Page 6 "Auto Shut Off")

Step 4: To change the fan speed between HIGH and LOW, press the FAN button. The indicator light will show the setting you have selected. The higher fan speed will result in quicker moisture removal.

Step 5: To shut the dehumidifier down, press the POWER button again.

4. Timer Setting

The TIMER function enables you to either delay AUTO-ON or delay AUTO-OFF the dehumidifier in the choice from 1 hour to 24 hours.

- **Setting an AUTO-ON timer:** When the dehumidifier is off, selecting Timer will turn the dehumidifier on in the hours that will be set.
- **Setting an AUTO-OFF timer:** When the dehumidifier is running, selecting Timer will turn the dehumidifier off in the hours that will be set.

Follow the below steps to set the TIMER:

- 1) Press the TIMER button once, the TIMER indicator will illuminate and the LCD turn to display as 00 and flash;
- 2) Press the TIMER button repeatedly to change the delay timer at 1-hour increments, up to 24 hours;
- 3) After selecting the target timer value, wait for 5 seconds to let the setting be registered automatically;
- 4) After TIMER setting finishes, the control will count down the time remaining (8,7,6, etc.) until the dehumidifier either AUTO-ON or AUTO-OFF.
- 5) After timer function enabled, press the TIMER button again to check the time remaining.

Note:

- Before entering AUTO ON timer setting, turn on the dehumidifier to set a target humidity level first. Otherwise, the humidity maintained will be the same as the previous setting.
- You can only set AUTO ON timer when the dehumidifier is off or set AUTO OFF timer when the dehumidifier is on, but you will not be able to set both AUTO ON and AUTO OFF timer at the same time.
- The TIMER will ONLY function one time instead of cycling the dehumidifier on or off indefinitely.
- Before entering the TIMER setting, make sure power is being supplied to the dehumidifier.
- Set the timer 00, the timer function will not be activated.
- Once the dehumidifier has been turned ON/OFF manually, the pre-set AUTO ON/OFF timer setting will be canceled.

5. Smart Functions

Auto Shut Off

When the bucket is full and/or the humidity setting is reached, the dehumidifier will shut off automatically.

- 1) When the water bucket is full, the FULL indicator will illuminate and the dehumidifier will make a beep sound for a few seconds.
- 2) When the room humidity is down to the set-point, the power button indicator and the humidity reading on the LCD will flash.

3-Minute Delay Protection Mechanism

To avoid any damage to the dehumidifier, the dehumidifier will not start operation following a complete cycle until after 3 minutes, which is called the 3-minute delay protection mechanism. That is to say, it takes 3 minutes to restart the compressor when its operation has been interrupted. During this 3 minutes, only the fan is running, and the power button indicator will keep flickering until the compressor kicks in.

Auto Defrost

When the frost builds up on the evaporator coils, the compressor will cycle off and the fan will continue to run until the frost disappears. (* See details on Page 4 “Defrost Indicator”.)

Auto-Restart

If the dehumidifier shuts off unexpectedly due to power being cut, the dehumidifier will restart with the previous function setting (set humidity and fan speed) automatically when the power resumes.

6. Removing Collected Water

1) Emptying the Water Bucket

When the bucket is full, the dehumidifier will automatically shut down and make a beep sound for 5 seconds. Meanwhile, the FULL indicator will illuminate. Do not move the dehumidifier at this time in case the water spills on the floor.

To remove the bucket to empty the collected water:

- a. Gently remove the bucket from the dehumidifier by gripping both sides and pulling outward;
- b. Pour the condensate out from the side without float to prevent the float from being flushed away with water.
- c. Replace the water bucket in the dehumidifier. The dehumidifier will not function without the bucket being installed.

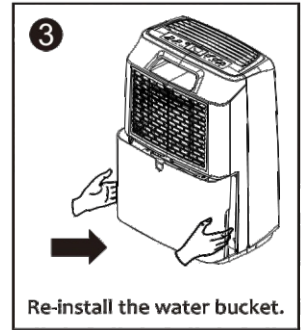
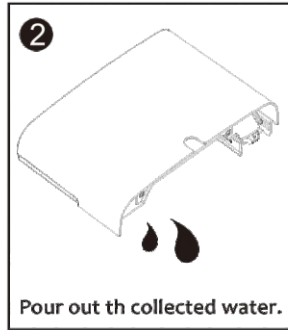
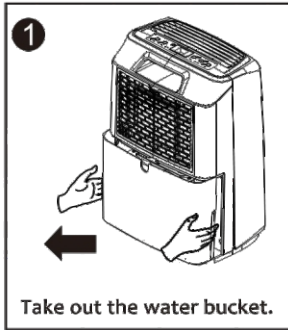

2) Continuous Draining

Water can be automatically emptied into a floor drain by attaching the included drain hose. (NOTE: You can use any other hoses with inner diameter of 5/8 inches instead.)

To Achieve Continuous Drain by Gravity:

- Remove the water bucket;
- Find the drain port on the back of the dehumidifier;
- Attach one end of drain hose to the drain port securely;
- Replace the water bucket in the dehumidifier properly;
- Direct the other end of the hose down to a suitable drainage facility, like a floor drain. The drainage facility should be lower than the drain outlet of the dehumidifier.

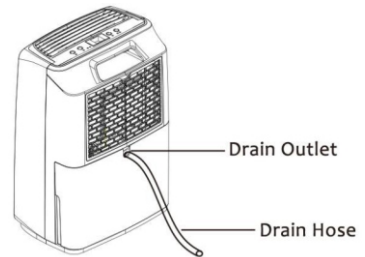

Note:

- Make sure the connection is tight and there is no leaking.
- Be sure to run the water hose sloping downward to let the water flow out smoothly. No kinks or bent.
- If the condensation water would be drained out to an external container via the hose, be sure NOT to submerge the other end of the hose into the drained out water.
- To improve gravity draining, you can raise the dehumidifier onto another higher and flat surface, like a table.
- It is recommended to use a short hose. If the drain hose is too long, water may not drain completely, which can lead to stagnant water and mildew build up inside the hose.
- When the continuous drain feature is not being used, remove the drain hose from the outlet.

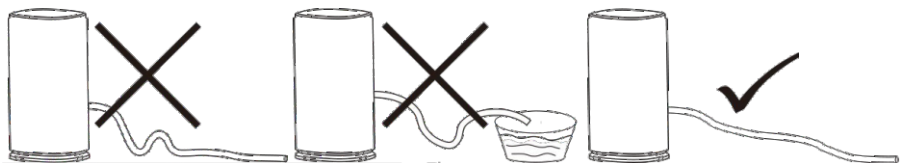

Care & Cleaning

To avoid possible electric shock, ensure to turn the dehumidifier off and disconnect the plug from the power source before performing any cleaning or maintenance.

1. Clean the Vent and Case

- Use water and a mild detergent. Do not use bleach or abrasives.
- Do not splash water directly onto the dehumidifier. Doing so may cause an electric shock or the insulation to deteriorate, or cause the dehumidifier to rust.
- The air intake and outlet vents get soiled easily, so use a vacuum attachment or brush to clean.

2. Clean the Reservoir

- Every few weeks, clean the reservoir to prevent the growth of mold, mildew, and bacteria.
- Partially fill the reservoir with clean water and add a little mild detergent. Swish it around in the reservoir, empty and rinse.

NOTE: Do not clean the reservoir in a dishwasher.

3. Clean the Air Filter

The air filter should be cleaned approximately every 2 weeks. The air filter may require more frequent cleaning if there is significant dander or fur in the air.

Follow the steps below to clean the filter:

- The air filter is located behind the rear intake grill. Remove the intake grill from the dehumidifier and take the filter out.
- Use a vacuum cleaner with a soft brush attachment to remove any large debris or dust build-up from the air filter.
- Wash the filter in lukewarm, soapy water, below 40°C (104°F), or use a neutral cleaning agent.
- Rinse the filter with clean water and dry thoroughly.
- Re-install the filter.

NOTE: DO NOT operate the dehumidifier without a filter because dirt and lint will clog it, reducing performance.

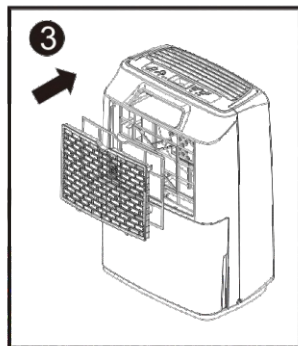
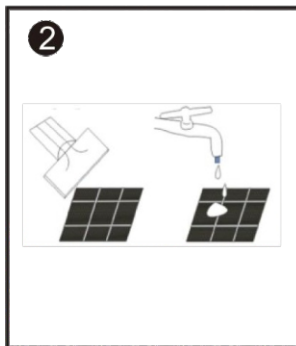
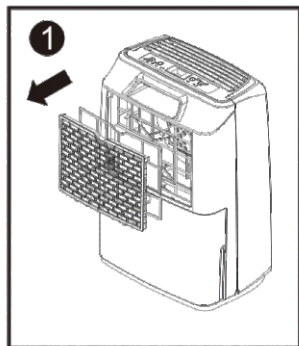

4. Store the Dehumidifier

When not using the dehumidifier for a long period, please follow the below steps to clean the dehumidifier and store it properly.

- Operate the dehumidifier on high fan mode for half a day, and then wait 1 day before emptying the reservoir.
- Clean the dehumidifier housing, water reservoir, and air filter. Ensure the whole dehumidifier is clean and dry.
- Take out the water bucket, put the plug and as possible cord into the water bucket, and then replace the bucket in the dehumidifier.
- Cover the dehumidifier with a plastic bag.
- Store the dehumidifier upright in a dry, well-ventilated place.

Troubleshooting

Problem	Possible Causes	Solutions
Dehumidifier can not turn on	The power cord is unplugged.	Plug it in.
	The fuse is blown or circuit breaker is tripped.	Check the fuse or the circuit breaker.
Dehumidifier is on, but it does not run.	Water bucket is full or not in the proper position.	Make sure the water bucket is empty and has been installed properly.
	The room humidity has reached the set-point and the dehumidifier enters into Standby Mode where the power indicator and the LCD reading flash.	Set a lower humidity or let the dehumidifier keep standby.
	The room humidity is lower than set humidity, so the dehumidifier enters into Standby Mode where the power indicator and the LCD reading flash.	The set humidity needs to be at least 5% (recommend 10%) lower than room humidity.
	The dehumidifier is in the defrosting process.	It is normal the compressor ceases while defrosting process.
Insufficient dehumidifying	Insufficient dehumidifying time.	When first installed, allow at least 3-4 days to maintain the desired RH.
	The room has not been sealed properly.	Ensure that all doors, windows and other openings are closed.
	Air filter is dirty.	Clean the air filter.
	Air flow has been blocked.	Ensure there are no obstructions block the airflow.
	There is something giving off water vapor in the room.	Remove those items or turn off such devices that give off vapor in the room.
	Room temperature is low.	Heat up the room.
Dehumidifier operates continuously	The dehumidifier size is too small for application.	Increase the quantity of dehumidifier. Or change a higher capacity dehumidifier.
	Check if the dehumidifier is in CONTINUOUS MODE.	Don't set the humidity too low. Typically, 40-50% are good settings to use.
	Room humidity is too high.	Change humidity settings. Or change a higher capacity dehumidifier.
Noise	Doors and windows are open.	Ensure that all doors, windows and other openings are closed.
	The dehumidifier is not positioned level.	Position the dehumidifier on a level surface.
	The water bucket is not in proper position.	Re-install the water bucket properly.
Frost appears on the coils	The air filter is clogged.	Wash the filter.
	The dehumidifier has been turned on recently.	This is normal frost builds up on the coils, especially when the room temperature is low. The dehumidifier will defrost automatically.
	Room temperature is close to or lower than 60°F.	
Water leakage	Hose connection is loose.	Check the hose connection. Try to attach the other end of the hose to the outlet.
Water does not drain from the hose	Hose connection is loose.	Check the hose connection. Try to attach the other end of the hose to the outlet.
	Water flow has been restricted.	Hoses more than 7 feet long may not drain properly. It is recommended to keep the hose as short as possible for proper draining. The hose must be placed lower than the bottom of the dehumidifier, and be kept flat and smooth without kinks.

Problem	Possible Causes	Solutions
Humidity always shows "25%RH" (there is a big difference from the actual humidity)	Humidity sensor failure?	Set the humidity to 30%RH,the dehumidifier can still continue to work, and can be used normally.
		Repair and replace the humidity sensor.
Humidity always shows "99%RH" (there is a big difference from the actual humidity)	1.Water on the surface of humidity sensor? 2.Humidity sensor failure?	The dehumidifier is not affected and can continue to work, and can be used normally.
		Please let the dehumidifier keeps working for a period of time, after the water on the surface of the humidity sensor is removed, it will return to normal.
		Repair and replace the humidity sensor.

Safety Precautions



1. When using, do not place the dehumidifier on soft, uneven ground to avoid vibration or movement.

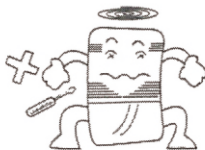

2. Do not use thin rods or hard objects to insert into the fuselage to avoid malfunction or danger.

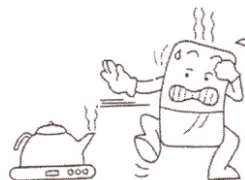

3. When using, please keep the dehumidifier away from heat sources such as heaters and electric kettles to save electricity.



4. When using, please close the doors and windows to achieve the best dehumidification effect.



5. Do not place items before and after the dehumidifier. If the ventilation is blocked, the dehumidification effect will be affected.



6. In case of power failure or long-term non-use, please unplug the power cord.



7. When cleaning the dehumidifier, gently wipe it with a damp cloth, do not directly spray water to clean it.

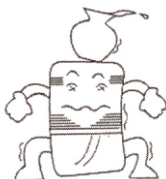

8. Do not place any objects on the dehumidifier.



9. Please clean the filter every two weeks (do not use hot water above 104°F/40°C, alcohol, gasoline, or toluene).



10. During continuous drainage, the drainage pipe must be placed horizontally or downwards, and must not be uneven or entangled.



11. After the filter is cleaned, please do not place it in direct sunlight to dry it to avoid deformation.



12. Before moving or carrying the dehumidifier, please pour out the accumulated water in the water tank.

Service

ANDTE offers a limited 1-year free warranty on this PD161A dehumidifier, with original proof of purchase (typically you may be only requested to offer the order number or other information to prove a genuine purchase, instead of an invoice)

and where a defect has arisen, wholly or substantially, as a result of faulty manufacture, parts or workmanship during the warranty period.

During the warranty period, for the damaged part, we will provide a replacement part if it can be restored to normal use by replacing parts.

The warranty does not apply where damage is caused by other factors, including without limitation:

- Normal wear and tear;
- Abuse, mishandling, accident, or failure to follow operating instructions;
- Exposure to liquid or infiltration of foreign particles;
- Servicing or modifications of the product other than by ANDTE.

We will try our best to inspect the dehumidifier through photos or videos to troubleshoot and ensure that we can better solve the problem for you.

These are our general terms for warranty service, but we always urge our customers to reach out to us with any issue, regardless of warranty terms.

For more warranty information

Please contact us in [**AndteServices@outlook.com**](mailto:AndteServices@outlook.com).

Warranty and Service

If you have an issue with an ANDTE product, please contact us at [**AndteServices@outlook.com**](mailto:AndteServices@outlook.com), and we will do our best to resolve it for you.



Support Hours

24 Hours available

*Please have your order number before contacting customer support.

Product Certification

The product is approved to leave the factory after passing the inspection.
Production date: see the nameplate or barcode of the fuselage





ANDTE