

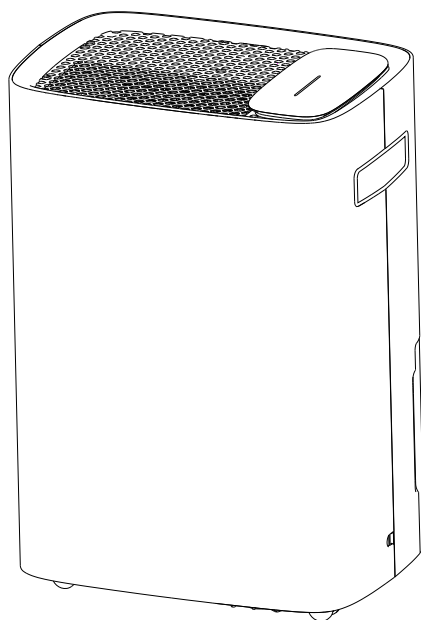

# Home Dehumidifier User Manual



Please read this user manual before operating and save for future reference.

Model: PD80K

# SAFETY AWARENESS

## Very Important!

Please do not install or use your dehumidifier before you have carefully read this manual. Please keep this instruction manual for an eventual product warranty and for future reference.

## WARNING

Do not use means to accelerate the defrosting process or to clean, other than those recommended by the manufacturer.

The appliance shall be stored in a room without continuously operating ignition sources (for example: open flames, an operating gas appliance or an operating electric heater. )

Do not pierce or burn.

Be aware the refrigerants may not contain an odour.



**A2L**

## Warning (for R32)

Specific information regarding appliances with R32 refrigerant gas.

- Thoroughly read all of the warnings.
- When defrosting and cleaning the appliance, do not use any tools other than those recommended by the manufacturing company.
- The appliance must be placed in an area without any continuously sources of ignition (for example: open flames, gas or electrical appliances in operation).
- Do not puncture and do not burn.
- R32 is a refrigerant gas that complies with the European directives on the environment. Do not, puncture any part of the refrigerant circuit.
- If the appliance is installed, operated or stored in an unventilated area, the room must be designed to prevent to the accumulation of refrigerant leaks resulting in a risk of fire or explosion due to ignition of the refrigerant caused by electric heaters, stoves, or other sources of ignition.
- The appliance must be stored in such a way as to prevent mechanical failure.
- Individuals who operate or work on the refrigerant circuit must have the appropriate certification issued by an accredited organization that ensures competence in handling refrigerants according to a specific evaluation recognized by associations in the industry.

- Repairs must be performed based on the recommendation from the manufacturing company. Maintenance and repairs that require the assistance of other qualified personnel must be performed under the supervision of an individual specified in the use of flammable refrigerants.
- Ducts connected to an appliance shall not contain a potential ignition source.
- **WARNING-Risk Of Fire. Flammable Refrigerant Used. To Be Repaired Only By Trained Service Personnel. Do Not Puncture Refrigerant Tubing.**
- **WARNING-Risk Of Fire. Dispose Of Properly In Accordance With Federal Or Local Regulations. Flammable Refrigerant Used.**
- **WARNING-Risk Of Fire. Flammable Refrigerant Used. Consult Repair Manual/Owner's Guide Before Attempting To Service This Product. All Safety Precautions Must Be Followed.**
- **WARNING-Risk of Fire due to Flammable Refrigerant Used. Follow Handling Instructions Carefully in Compliance with National Regulations.**

## **Instructions For Repairing Appliances Containing R32**

### **General Instructions**

- Checks to the area Prior to beginning work on systems containing flammable refrigerants, safety checks are necessary to ensure that the risk of ignition is minimised. For repair to the refrigerating system, the following precautions shall be complied with prior to conducting work on the system.
- Ventilated area Ensure that the area is in the open or that it is adequately ventilated before breaking into the system or conducting any hot work. A degree of ventilation shall continue during the period that the work is carried out. The ventilation should safely disperse any released refrigerant and preferably expel it externally into the atmosphere.

### **Detection of flammable refrigerants**

- Under no circumstances shall potential sources of ignition be used in the searching for or detection of refrigerant leaks. A halide torch (or any other detector using a naked flame) shall not be used.
- The following leak detection methods are deemed acceptable for all refrigerant systems.
- Electronic leak detectors may be used to detect refrigerant leaks but, in the case of FLAMMABLE REFRIGERANTS, the sensitivity may not be adequate, or may need re-calibration. (Detection equipment shall be calibrated in a refrigerant-free area.) Ensure that the detector is not a potential source of ignition and is suitable for the refrigerant used. Leak detection equipment shall be set at a percentage of the LFL of the refrigerant and shall be calibrated to the refrigerant employed, and the appropriate percentage of gas (25 % maximum) is confirmed.

- Leak detection fluids are also suitable for use with most refrigerants but the use of detergents containing chlorine shall be avoided as the chlorine may react with the refrigerant and corrode the copper pipe-work.

### **Note Examples of leak detection fluids are**

- bubble method,
- fluorescent method agents.

If a leak is suspected, all naked flames shall be removed/extinguished. If a leakage of refrigerant is found which requires brazing, all of the refrigerant shall be recovered from the system, or isolated (by means of shut off valves) in a part of the system remote from the leak.

### **General Safety Instruction**

1. The appliance is for indoor use only.
2. Do not use the unit on a socket under repairs or not installed properly.
3. Do not use the unit, follow these precautions:
  - A: Near to source of fire.
  - B: An area where oil is likely to splash.
  - C: An area exposed to direct sunlight.
  - D: An area where water is likely to splash.
4. All the air-conditioner sockets must comply with the local electric safety requirements. If necessary, please check it for the requirements.
5. Children should be supervised to ensure that they do not play with the appliance.
6. If the supply cord is damaged, it must be replaced by the manufacturer, its service agent or similarly qualified persons in order to avoid a hazard.
7. This appliance can be used by children aged from 8 years and above and persons with reduced physical, sensory or mental capabilities or lack of experience and knowledge if they have been given supervision or instruction concerning use of the appliance in a safe way and understand the hazards involved. Children shall not play with the appliance. Cleaning and user maintenance shall not be made by children without supervision.
8. This appliance is not intended for use by persons (including children) with reduced physical, sensory or mental capabilities, or lack of experience and knowledge, unless they have been given supervision or instruction concerning use of the appliance by a person responsible for their safety.
9. The appliance shall be installed in accordance with national wiring regulations.



## 10. Recycling



This marking indicates that this product should not be disposed with other household wastes. To prevent possible harm to the environment or human health from uncontrolled waste disposal recycle it responsibly to promote the sustainable reuse of material resources. To return your used device, please use the return and collection systems or contact the retailer where the product was purchased. They can take this product for environmental safe recycling.

11. Contact authorized service technician for repair or maintenance of this unit.
12. Do not pull deform. or modify the power supply cord, or immerse it in water. Pulling or misuse of the power supply cord can result in damage to the unit and cause electrical shock.
13. Compliance with national gas regulations shall be observed.
14. Keep ventilation openings clear of obstruction.
15. Any person who is involved with working on or breaking into a refrigerant circuit should hold a current valid certificate from an industry-accredited assessment authority, which authorizes their competence to handle refrigerants safely in accordance with an industry recognized assessment specification.
16. Servicing shall only be performed as recommended by the equipment manufacturer. Maintenance and repair requiring the assistance of other skilled personnel shall be carried out under the supervision of the person competent in the use of flammable refrigerants.
17. Do not operate or stop the unit by inserting or pulling out Die power plug, it may cause electric shock or fire due to heat generation.
18. Unplug the unit if strange sounds, smell, or smoke comes from it.
19. Install the dehumidifier on flat surface to minimize vibration and or noise.
20. Inspect the power cord before use. Never operate the dehumidifier when the power cord or plug is damaged.
21. Insert the three-prong plug on the power cord into a matching electrically grounded outlet (115V/ 60 Hz, 16 A at least).
22. Do not use an adapter. Never cut off the third prong. Do not use an extension cord.
23. Do not operate the dehumidifier in standing water. Keep motor and wiring dry.
24. Never immerse the dehumidifier into water or other liquids.
25. Do not put the dehumidifier close to heat-generating devices, including flammable or dangerous materials.

26. Unplug the power supply before cleaning or storing the dehumidifier. Always grasp the plug (not the cord) to unplug.
27. Do not put fingers or other items into air inlet or air outlet.
28. Never insert any other objects into the dehumidifier body.
29. Do not sit, stand or put heavy objects on the dehumidifier.

- If any parts damage, please contact the dealer or a designated repair shop;
- In case of any damage, please turn off the air switch, disconnect the power supply, and contact the dealer or a designated repair shop;
- In any case, the power cord shall be firmly grounded;
- To avoid the possibility of danger, if power cord is damaged, please turn off the air switch and disconnect the power supply. It must be replaced from the dealer or a designated repair shop.



**Never repair or remove plug and or power cord. Any repairs should be completed by qualified electrician or distributor.**

## BEFORE FIRST USE:

To prevent any internal damage, it is very important to keep refrigeration units (like this one) upright throughout their journey.

Please leave it standing upright and outside the box for **24 HOURS** before plugging it in.

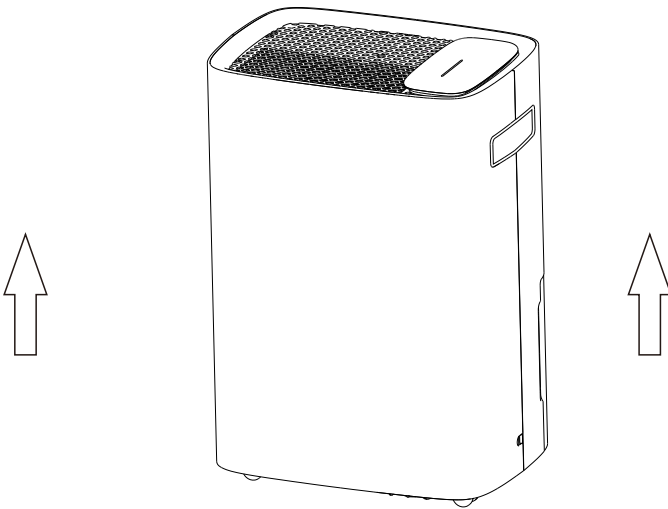

---

# Welcome

Thanks for choosing **ANDTE** dehumidifier!

**ANDTE** is dedicated to keeping people healthy, comfortable and more enjoyable by offering quality appliances ranging from dehumidifiers to ice makers, and more. From breathing easier in your office to upgrading your kitchen appliances, we hope **ANDTE** could help you every step of the way.

**READ THIS MANUAL INSTRUCTION CAREFULLY BEFORE USING THE UNIT.  
PLEASE KEEP THIS FOR FUTURE REFERENCE.**

ANDTE PD80K home dehumidifier reducing humidity to comfortable levels in a short period of time. This dehumidifier has a sturdy housing to withstand harsh environments, is safe and easy to use, guarantees long-term use and easy maintenance, plus we use a copper tube condenser and high quality and accurate sensors, it will be more effective and last longer.

Before plugging in your new dehumidifier, we suggest that you read this user manual as it contains important safety information, operation instructions, troubleshooting, maintenance tips, and warranty information to ensure the reliability and longevity of your dehumidifier.

## We're always just an email away

To access customer support, please email to [AndteServices@outlook.com](mailto:AndteServices@outlook.com) with your purchase order.

Thank you again!

---

---

# TABLE OF CONTENTS

Safety Instructions .....	01
Parts Description .....	02
Control Interface .....	03
Operation Instructions .....	04
Cleaning and Maintenance .....	12
Common Faults and Solutions .....	13
Safety Note .....	16
Service.....	17

## Statement

The graphics and functions provided in this manual may not be the same as the actual product. Please always refer to the actual product.

The model of the machine on the manual is for reference only. Please check the corresponding content and operate the machine based on the actual product.

The right to interpret the relevant terms belongs to the company.

---

# SAFETY INSTRUCTIONS

## Safety Notes:

For your safety, please read the manual carefully and keep the manual before you use the manual for reference.

Please use this product according to the instructions of installation and operation of this manual.

- Before cleaning the dehumidifier, turn off the power and unplug it from the power outlet.
- Please do not place the machine near any heat source or flammable goods.
- Do not insert your fingers or sticks into the air inlet or outlet.
- Always keep the machine on even surface, instead of placing on uneven or slopping ground.
- Do not spray water, insecticides or flammable liquids on the unit.
- This machine should not be placed in a confined and narrow space.
- When the power cord is damaged, it must be replaced by the qualified technician approved by our company.
- When using the dry clothes function, the clothes should be kept at least 40cm away from the air to prevent water from entering the outlet and damage the machine.
- The machine power wiring must be in accordance with national wiring rules, and, power line should be connected to the reliable external Earth Line.
- The fixed wiring of the machine connection must be equipped with an all-pole disconnect device (air switch) with at least 0.118-inch distance of electric shock.
- Model specification of safety tube:3.15A.
- This appliance can not be used by children aged under 8 years old and persons with reduced physical, sensory or mental capabilities or lack of experience and knowledge unless they have been given supervision or instructions concerning use of the appliance in a safe way and understand the hazards involved. Children shall not play with the appliance. Cleaning and user maintenance shall not be made by children without supervision.
- When using dehumidifier, other objects surrounding the machine need to be kept at least a distance of 7.9 inches (20cm) as shown in the picture on the right:

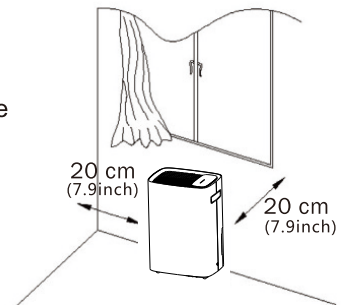

# Parts Identification

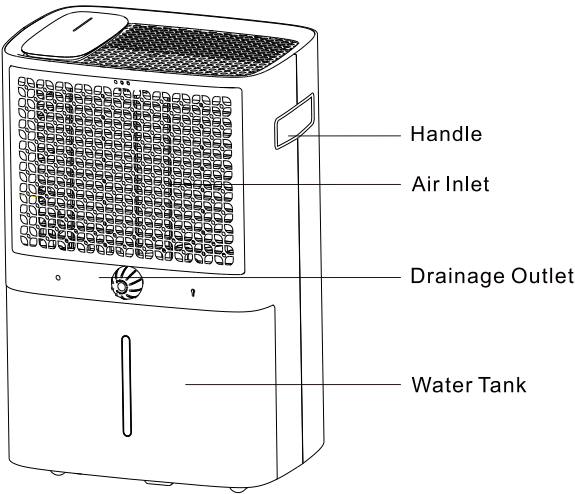
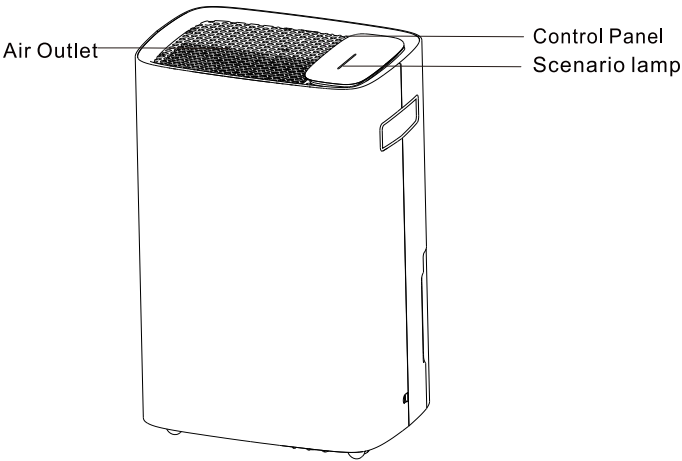

# Operation Instructions

## 1.Control Panel



### POWER Button

To turn the dehumidifier ON/OFF.



### MODE Button

To select working mode between DEHU, DRY, CONT.



### TIMER Button

To set auto ON/OFF timer in 1-24 hrs.



### SPEED Button

To select fan speed between high and low.



### HUMIDITY Button

To set the humidity within a range of 30%RH to 80%RH in 5% increments



### LOCK Button

It is used to open and release the child lock function.



### WATER FULL Indicator

Indicates the water tank is full.





## 2.Setting

### Setting Humidity

The humidity level can be set within a range of 30%RH to 80%RH in 5% increments.

- -When it starts to work, it will first automatically detect and show the room's humidity. Press the "SETTING" button to change the humidity selection in 5% increments. " **88** " will Flash and show the setting humidity.
- -Press "SETTING" to make the humidity increase OR decrease by 5%RH.
- -After no operation for 5s, " **88** " will show the actual room humidity.
- -When the humidity level is higher or drops to the level you have set, the dehumidifier will automatically begin to work or stop.
- -When the humidity level is set at 30%RH, the dehumidifier will work at continuous dehumidifying mode.

### Child Lock Setting

Press and hold the "  " button for 3-5 seconds to lock or unlock the control panel. When the "  " function has been activated, the indicator illuminates, and other buttons will be disabled. To regain use of the buttons, unlock the control button.

### Timer Setting

This TIMER setting function is designed for you to set a time to turn off or turn on the machine, automatically by the timer.

1. Press the "TIMER" button to select the timer by 1-hour increment. You can set the timer up to 24 hours. It will start to do the countdown when you start the timer.
2. Press and hold the "TIMER" button for several seconds to make the selection of the timer faster.
3. If the time is set to 00, this is called the invalid time. If you set the timer successfully, the light "TIMER" will be up. The LED screen will show the remaining time if you press the "TIMER" button, and display the current humidity automatically after a few seconds.

# Operation Instructions

## Speed Button

Control the fan speed. Press to select either High or Normal fan speed. Higher fan speed will result in quicker moisture removal. Set the speed high for maximum moisture removal. When the humidity has been reduced and quiet operation is more preferred, set the fan speed back to Normal.

## DRY (Laundry Dry) Mode



Press the "  " button until you see the "DRY" indicator light up on the display to select DRY-CLOTHES mode. In the DRY mode, the dehumidifier will run continuously at high fan speed.

Note: In the DRY mode, the SETTING button and the SPEED button is disabled.

## CONT (Continuous) Mode

Press the "  " button until you see the CONT indicator light up on the display to select continuous mode. In CONT mode, the dehumidifier will run continuously until the water tank is full.

## Overflow Protection

When the water tank is full of water, the machine will turn off automatically. The indicator light "  " will flash. After you empty the water from the water tank, the indicator light "  " will turn off. The machine will restart to work.

## Caution:

**Water tank must be placed in right position, otherwise will cause the water full alarm.**

## Convenient Drainage

When the water tank is full, the Full Tank indicator will light up. No need to check the tank from time to time.

**Auto Drainage:** The dehumidifier has continuous drainage outlet where you can just simply attach the 6.56 ft. hose for continuous draining.

**Manual Drainage:** When the water tank is full, the "Full Tank" indicator will light up, the dehumidifier will automatically switch off and will start to turn on automatically when the tank is emptied and placed back to the unit.

## More Functions

### Auto Shut-off

When the water tank is full and or the room humidity reaches the setting value, the dehumidifier will stop working automatically.

### 3 Minutes Delay Protection

The compressor features the "3 minutes delay protection" function— When the dehumidifier is powered, the compressor can only start again 3 minutes after its last shutdown.

### Auto Defrost

When the dehumidifier is running at a lower temperature, the system will automatically determine whether there is a presence of frost. If any frost exists, it will defrost automatically.

The fan will runs at high wind speed and the compressor will stop. During the defrosting process, the POWER indicator will flash.







### Auto Restart

If the dehumidifier shut off unexpectedly due to the power outage while it's running or in standby mode, the dehumidifier will restart with the previous function setting (working mode, setting humidity value and fan speed, etc.) automatically when the power resumes.

## 4Scene light settings

S/N	Lamp color	Applicable status
1	Light cyan	$0\% \leq \text{Ambient humidity} \leq 39\%$
2	Light green	$40\% \leq \text{Ambient humidity} \leq 60\%$
3	Blue	$61\% \leq \text{Ambient humidity} \leq 80\%$
4	Orange	$81\% \leq \text{Ambient humidity} \leq 100\%$

### 3. Display Status Description

- When the device is currently powered on, before switching on the machine for further operations, only the power button light up.
- Setting light "  " If the timer is set up properly, the indicator light will be up, flash if press TIMER button again to check and reset, and go out if non-successful setup.
- High-speed indicator light "  ": If you set the unit to high speed fan mode, the indicator will light up.  
Low-speed indicator light "  ": If you set the unit to low speed fan mode, the indicator will light up.
- Dehumidification light "  ": When the machine starts to dehumidify, the indicator light will be on.
- Water full light indicator "  " When the water tank is full, this indicator will flash.
- When the dehumidifier normally works, "  " will show the current humidity.

### 4. Instructions for Drying Clothes

1. The dehumidifier can be used for drying clothes in rainy weather.

#### Step 1.

Hang the washed clothes in a small space such as cloakroom, bathroom, or storage room.

Note: Keep away the unit from the water drips of the washed clothes.

#### Step 2.

Open the dehumidifier and set the humidity level at 30%RH. It is best if you let the air outlet of the dehumidifier to blow air to the clothes directly.

2. The drying effect will vary from the thickness of clothes, the number of clothes and the size of the drying space. Theoretically, the effect will be better when clothes are few, thin and space is small.

3. The drying process would take 3-8 hours, and we suggest that continuous drainage mode would be more suitable when drying clothes.

## 5. Faults & Processing Methods

Fault Phenomenon	Analysis of Causes	Processing Method
Humidity always shows "25%RH"(There is a big difference from the actual humidity)	Humidity sensor failure?	Set the humidity to 30%RH, the dehumidifier can still continue to work, and can be used normally.
		Repair and replace the humidity sensor.
Humidity always shows "99%RH"(There is a big difference from the actual humidity)	1. Water on the surface of the humidity sensor? 2.Humidity sensor failure?	The dehumidifier is not affected and can continue to work, and can be used normally.
		Please let the dehumidifier keep working for a period of time, after the water on the surface of humidity sensor is removed, it will return to normal.
		Repair and replace the humidity sensor.

**Note:**

Before starting the machine, please ensure that the air outlet has been opened, otherwise the machine will overheat. Do not pull out the power cord directly to stop the machine.

## 6. Empty The Water Tank

Two ways are available to remove the collected water.

### Use The Water Tank

When the water tank is already full, the WATER FULL indicator will light up, the dehumidifier will automatically shut down until the tank has been emptied and placed back to the unit.

### Ways to Empty the Water Tank

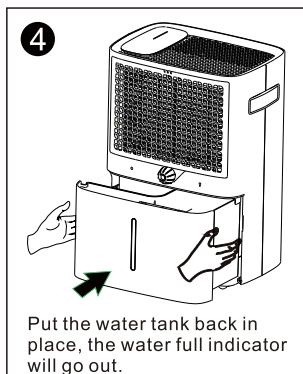
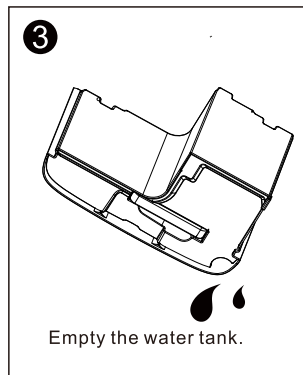
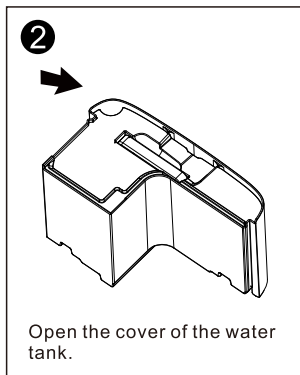
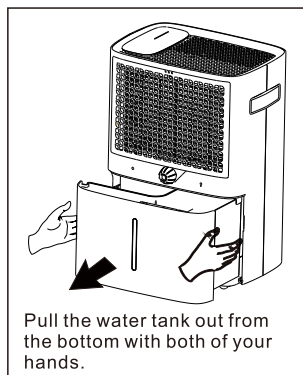

# Operation Instructions

## Note:

- Do not remove the float from the water tank. If the float in the water tank is removed, the sensor may not be able to determine the water level stored in the tank properly that may lead to water overflow leak from the water tank.
- If the water tank is dirty, just use cold water or warm water to clean it. Do not use detergent, steel wool, chemically treated dust cloth, gasoline, benzene, thinner or other solvents. Otherwise, it may damage the water tank and cause it to leak.
- When placing back the water tank, use your hands to press the tank back in its place. If the water tank is not placed properly, sensors or protections from water overflow may not operate as expected.

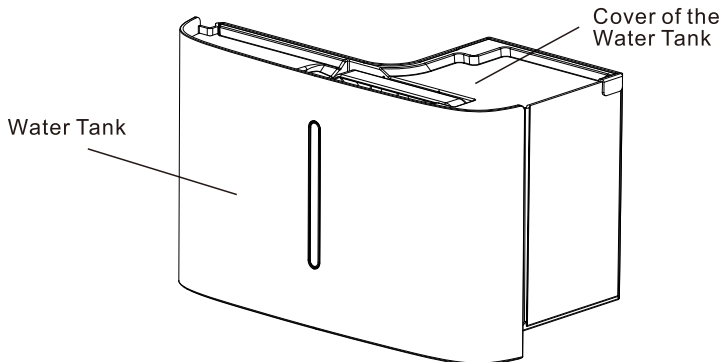

## 7. Continuous Drainage

Pull out the power supply, unscrew the drainage cap, remove the black rubber plug, insert the water hose into the continuous drainage port and push it back into the water tank.

Connect the power supply to start the operation. The water outlet of the water hose should be lower than the continuous drainage port by more than 3.9 inches, and the water hose cannot be bent.

(Note: The diameter of continuous drainage port is 0.63 inches.)

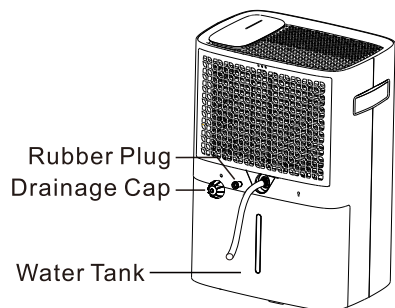
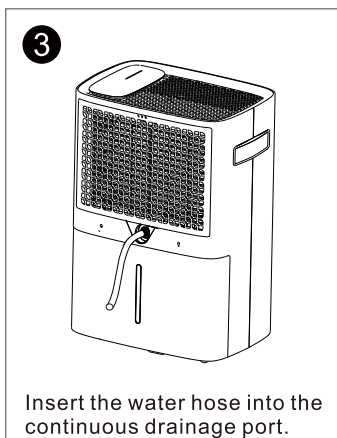
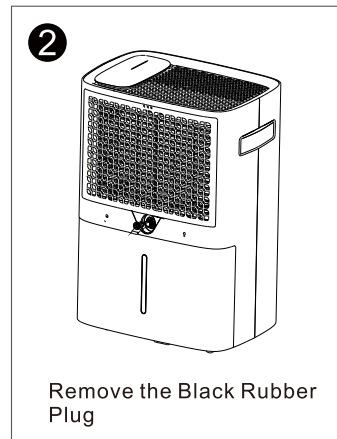
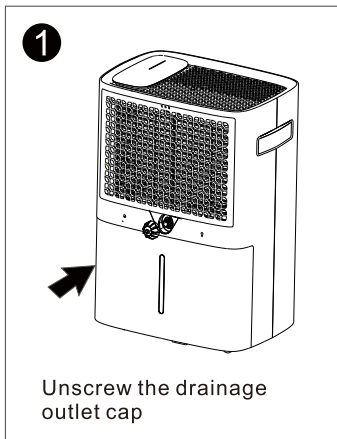



## Cleaning and Maintenance

### ▲ WARNING:

Turn the dehumidifier off and remove the plug from the wall outlet before Cleaning.

### A- Cleaning the dehumidifier body

Please use a soft and slightly wet textile or cloth to clean it.

### B- Cleaning filter

1. Pull out the filter.
2. Clean the filter: Use a vacuum cleaner to gently remove the dust from the surface of the filter. If the filter is very dirty, wipe it with warm water and a mild detergent and dry it completely.
3. Slowly insert the filter back to the machine body.

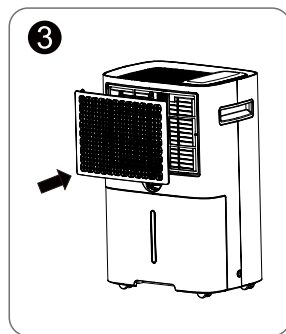
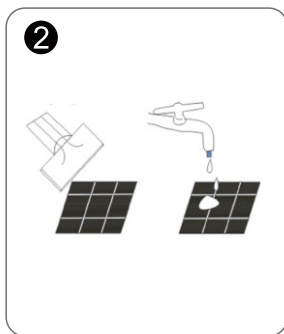
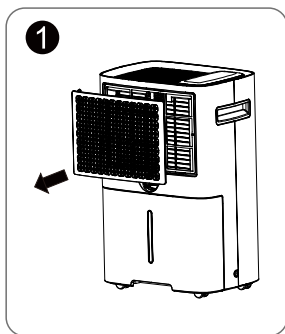

### C-Dehumidifier storage

When you want to store the dehumidifier because you don't use it for a long time. Please pay attention to the following steps:

1. Empty the water in the water tank.
2. Roll up the power cord and tie it up.
3. Clean the filter.
4. Cover the dehumidifier with a storage protection bag.
5. Place the machine in a cool and dry environment.

## Common Faults and Solutions

Check the information below for troubleshooting steps, it will save you time to resolve issues that may happen with the unit.

The list includes most of the common cases, but not the results of defective unit, crafts or materials in the unit.

If all troubleshooting steps have been exhausted and the issue is still occurring, please feel free to reach out to ANDTE Customer Service to get further assistance.

Problem	Reason	Method
Dehumidifier does not work	The power cord is unplugged.	Make sure that the unit's plug is inserted properly into the power outlet.
	Is the Full Tank indicator blinking? (The tank is full or in a wrong position.)	Empty the water in the water tank and then reposition the tank.
	Is the room temperature above 95°F (35°C) or below 41°F (5°C).	This product does not apply to over hot or cold environment, the machine will automatically enter the protection mode. It is a normal phenomenon.
	Is the room temperature between 41°F(5°C) and 68°F(20°C) ?	When running under lower ambient temperature, the machine will automatically defrost, which is a normal phenomenon. It will restart dehumidification again until the defrosting process finished.
	The dehumidifier is in the defrosting process.	It is normal the compressor ceases while defrosting process. Wait until the process finished, it will restart dehumidification again.
	Is the room humidity lower or reaching the preset humidity level? (When the room humidity has reached the preset level, the dehumidifier will enter Standby Mode and the indicator on LCD will flash. )	Please set the humidity 5%RH lower than the room humidity or set the humidity to 30%RH.
	This is to prevent the frequent start of the machine. Does the machine stop working just now?	Please wait for more than 3 minutes.
	Room humidity is low.	The dehumidifier is designed to work in the humidity range of 30%-80%. Above or below this range, it will not work.

## Common Faults and Solutions

Dehumidifier does not dry the air as it should	The air filter is dirty.	Clean the air filter.
	Is the air inlet or air outlet obstructed?	Remove the obstruction from the air inlet or outlet.
	The dehumidifier size is too small for application.	Increase the quantity of dehumidifier. Or change to a higher capacity dehumidifier.
	Poor air circulation.	Please leave about 20cm (7.9 inches) around the product.
	Do not allow enough time to remove the moisture.	Allow enough time to remove the moisture. When first installed, allow at least 3-4 days to maintain the desired RH.
	The room has not been sealed properly.	Check that all doors, windows and other openings are securely closed.
	Room temperature is too low, or below 41°F (5°C): The machine will not work or undergo poor dehumidifying efficiency in low temperature.	Please wait until the temperature rises to above 41°F (5°C) or higher.
The dehumidifier makes loud noise when operating	The dehumidifier is not positioned levelly.	Move the machine to a horizontal position.
	Is there blocking around the air inlet? The air filter is clogged.	Clean up the dirt or lint on the air outlet and intake.
	Is the filter installed correctly?	Please check whether the packing bag of the filter had been removed and the filter has been installed correctly.
Dehumidifier operates continuously	Check if the dehumidifier is in Continuous Mode	Do Not set the humidity too low. Typically, 40-50% are good for use.
	Room humidity is too high.	Change humidity settings. Or change to a higher capacity dehumidifier.
	Doors and windows are open.	Ensure that all doors, windows and other openings are closed.

## Common Faults and Solutions

Overflow of water on floor	Hose to connector or hose connection may be loose.	Connect the hose with the drainage port tightly.
	The water tank has not been installed properly.	Re-install the water tank properly.
	The float of water tank has been stuck.	Move the float and let it swing freely.
	The magnet on the float has come off.	Put the magnet in right position.

## Safety Note



- ① When using, please do not put the machine at the soft and uneven ground, avoid vibration and movement.



- ② Do not insert thin rods and hard objects into the machine body to avoid malfunction and danger.



- ③ When using, please keep the machine away from heating furnace, electric kettle and other heat sources.



- ④ When using, please close doors and windows to achieve the best remove humidity effect.



- ⑤ Please do not put objects around the body. If the ventilation is blocked, the dehumidification effect will be affected.



- ⑥ If do not use the product for a long time, please unplug the power cord.



- ⑦ When cleaning the dehumidifier, please use the wet textile to wipe gently, do not shoot the water directly.



- ⑧ Please do not put any object on the dehumidifier.



- ⑨ Please clean the filter every two weeks (do not use hot water above 104°F, alcohol, gasoline or toluene.)



- ⑩ When continuous drainage, the drain hose must be placed horizontally, without unevenness and winding.



- ⑪ After cleaning the filter, please do not dry it under direct sunlight, in case deformation.



- ⑫ Before moving and carrying the machine, please first pour out the water in the tank.

## Service

ANDTE offers a limited 1-year free warranty on this PD80K dehumidifier, with original proof of purchase (typically you may be only requested to offer the order number or other information to prove a genuine purchase, instead of an invoice)

and where a defect has arisen, wholly or substantially, as a result of faulty manufacture, parts or workmanship during the warranty period.

During the warranty period, for the damaged part, we will provide a replacement part if it can be restored to normal use by replacing parts.

The warranty does not apply where damage is caused by other factors, including without limitation:

- Normal wear and tear;
- Abuse, mishandling, accident, or failure to follow operating instructions;
- Exposure to liquid or infiltration of foreign particles;
- Servicing or modifications of the product other than by ANDTE.

We will try our best to inspect the dehumidifier through photos or videos to troubleshoot and ensure that we can better solve the problem for you.

These are our general terms for warranty service, but we always urge our customers to reach out to us with any issue, regardless of warranty terms.

### For more warranty information

Please contact us in [\*\*AndteServices@outlook.com\*\*](mailto:AndteServices@outlook.com).

## Warranty and Service

If you have an issue with an ANDTE product, please contact us at [\*\*AndteServices@outlook.com\*\*](mailto:AndteServices@outlook.com), and we will do our best to resolve it for you.



### Support Hours

24 Hours available

\*Please have your order number before contacting customer support.

#### Product Certification

The product is approved to leave the factory after passing the inspection.  
Production date: see the nameplate or barcode of the fuselage







**ANDTE**